



Addendum No. 3

City of Coquitlam

RFP No. 25-002

Burke Mountain Athletic Park Construction Services

Issue Date: May 30, 2025

Total Page Count: 15 (INCLUDING Architectural Addendum #03)

This Addendum is issued to Proponents registered as attending the Mandatory Site Meeting on Thursday, May 15, 2025. Proposals will only be received from the companies that are recorded on the City's Mandatory Site Visit Registration Form.

Proponents shall note the following amendments to the RFP documents:

AMENDMENTS

A1) CORRECTION

The following correction is issued by the Architect to revise their Drawings:

- **Architectural Addendum #03**

See Attachment No. 1 to this Addendum No. 3.

QUESTIONS

Q1. Is there any Geotech information of what the onsite existing fill material is (i.e. behind existing walls and across the site previously filled)

A1. The backfill behind the Lock-Block retaining walls consists of a 75 mm minus crushed gravel. This material was also used as backfill to achieve design grades elsewhere on site, as well as over the surface of the site. Till-like soils from the bulk excavation were also reused as fill in discrete locations.

Q2. We would like to request an extension for Burke Mountain Athletic Park Construction

A2. Addendum No. 1 extended the Closing Date and Time to Friday, June 6. At this time, the City does not intend to issue any further extensions. Proponents are advised to monitor the City's website for any additional addenda.

Q3. Can you provide a cross-section to cover the Rubber Track, Concrete Runnel, Fence, and Artificial Turf?

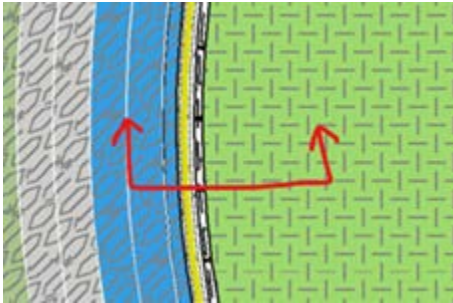

A3. Refer to VDZ's Drawing LD-08/1 Track Section Drawing

Q4. Please provide details and specifications for the pathway on the west side of the sports court.

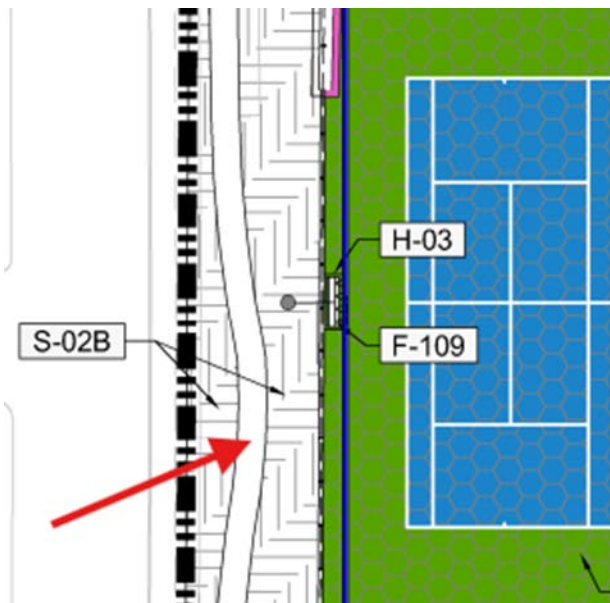

A4. This is an existing path and not included in Scope of Work.

Q5. Please clarify if a small shelter is required for the Scorer's Table area.

A5. Yes, a shelter is required for the scorer's table. Please refer to Architectural Addendum #3.

Q6. This detail seems unclear regarding the cast in place wall modification, could you please review it?

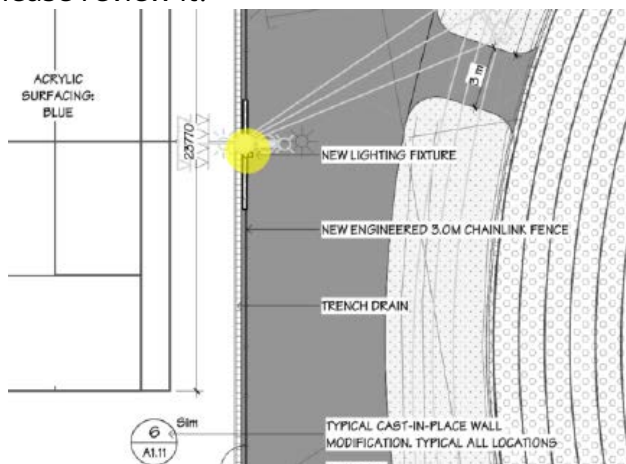

A6. The area highlighted in the question is not proposed to be modified. The cast in place wall modification areas are noted on the structural drawings, including the site plan and detail 2/S.1, and are on the west and south sides of the tennis court area.

Q7. Bleachers are used to furnishing specifications, now it moved to optional on the bid form, please confirm unit of measure “State” including two bleachers.

2.5 BLEACHERS

- .1 Supplier: Sports Systems Canada
- .2 Product Name: 5-Row Outdoor Bleachers
- .3 Product Number: BL-5TB-27DR
- .4 Size: 27'
- .5 Guardrail: Aluminum Picket Guardrail: Refer to product specifications from supplier
- .6 Quantity: 2

c) OPTIONAL ITEMS – PRICE - The following is a list of Optional Prices and forms part of this Contract, upon the acceptance of any or all of the Optional Prices by the City. The Optional Prices are a deduction from or addition to the Total Proposal Price and do not include GST. **DO NOT** state a revised Total Proposal Price.

ITEM	SCOPE OF WORK	Unit of Measure	PRICE (exclude GST)
i.	Rock face Shotcrete Wall on Lock Block Walls	Lot	\$
ii.	Anti-graffiti coating for Lock Block Walls	Lot	\$
iii.	Anti-graffiti coating for Shotcrete Wall	Lot	\$
iv.	Bleachers	State:	\$

A7. There are bleachers included in the base bid as per the drawings. Please confirm unit pricing for bleachers for reference. “State” means for the Proponent to provide the unit of measure (i.e. each, lot, pair, etc.)

Q8. Anti-graffiti coating for shotcrete wall, this supposed to be on Shotcrete Facing-Smooth face only, which is about 150m2 area, correct? Since this is stated in optional items, we shall not include this work in bid item Viii?

c) OPTIONAL ITEMS – PRICE - The following is a list of Optional Prices and forms part of this Contract, upon the acceptance of any or all of the Optional Prices by the City. The Optional Prices are a deduction from or addition to the Total Proposal Price and do not include GST. **DO NOT** state a revised Total Proposal Price.

ITEM	SCOPE OF WORK	Unit of Measure	PRICE (exclude GST)
i.	Rock face Shotcrete Wall on Lock Block Walls	Lot	\$
ii.	Anti-graffiti coating for Lock Block Walls	Lot	\$
iii.	Anti-graffiti coating for Shotcrete Wall	Lot	\$
iv.	Bleachers	State:	\$

vii.	Irrigation		\$
viii.	Shotcrete Facing		\$
ix.	Synthetic Turf, including supply and installation of		\$

A8. Anti-graffiti coating has been specified for smooth face shotcrete wall for locations as per drawings/specs. Confirm unit cost for anti-graffiti coating for remainder of smooth face shotcrete walls and lock block walls. Include estimated coverage (m2) for reference.

Q9. It doesn't seem like we need these goal anchors, please confirm where is should be used and for which equipment?

2.15 GOAL ANCHORS

- .1 Supplier: KWIK GOAL
- .2 Product Name: Goal Secure Turf Anchors
- .3 Product Number: 10B5301
- .4 **Quantity: 4 anchors (for 2 goals)**

A9. Include goal anchors.

Q10. Anti-graffiti coating for Lock block wall, on addendum#1 indicate on up to 3m high, in addendum No. 2, the 3m high has been removed, for Anti-graffiti coating, it is inexpensive, but not for shotcrete surfacing, for the fairness of pricing, could you please provide area of coverage (m2 of ft2) for item I instead of Lot?

City of Coquitlam
RFP No. 25-002 – Burke Mountain Athletic Park Construction Services
REVISION NO 1

c) OPTIONAL ITEMS – PRICE - The following is a list of Optional Prices and forms part of this Contract, upon the acceptance of any or all of the Optional Prices by the City. The Optional Prices are a deduction from or addition to the Total Proposal Price and do not include GST. **DO NOT** state a revised Total Proposal Price.

ITEM	SCOPE OF WORK	Unit of Measure	PRICE (exclude GST)
i.	Rock face Shotcrete Wall on Lock Block Walls		\$
ii.	Anti-graffiti coating for Lock Block Walls – 3m high		\$
iii.			\$

c) OPTIONAL ITEMS – PRICE - The following is a list of Optional Prices and forms part of this Contract, upon the acceptance of any or all of the Optional Prices by the City. The Optional Prices are a deduction from or addition to the Total Proposal Price and do not include GST. **DO NOT** state a revised Total Proposal Price.

ITEM	SCOPE OF WORK	Unit of Measure	PRICE (exclude GST)
i.	Rock face Shotcrete Wall on Lock Block Walls	Lot	\$
ii.	Anti-graffiti coating for Lock Block Walls	Lot	\$
iii.	Anti-graffiti coating for Shotcrete Wall	Lot	\$
iv.	Bleachers	State:	\$

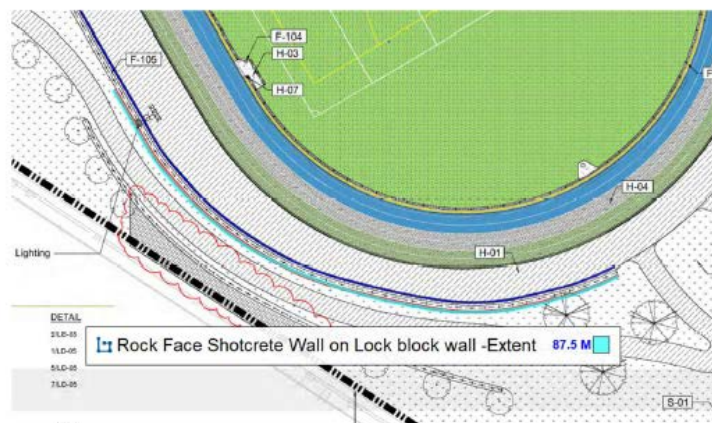

A10. Confirm unit cost and total coverage (m2) included when pricing for anti-graffiti coating for lockblock wall to allow for comparison.

Q11. In Proposal Submission Form there is a line others not listed, in unit price item there are swales not specified in any base bid item, are swales related material and work included in xxii or only in unit price?

	by item)		
xxii.	Other not Listed:		\$
	TOTAL		\$

43	150MM DIAMETER PVC SURGE STORM LEADS	LM	\$	\$
44	SWALE (1.2M)	LM	\$	\$
45	SWALE (1.0M)	LM	\$	\$
46	SWALE (0.5M)	LM	\$	\$
47	FRENCH DRAIN ASSEMBLY	LM	\$	\$

A11. All items included in drawings and specifications are to be included in base bid. Costs for any items not listed can be captured in breakdown under "Other".

Q12. Please confirm this unit price is for Secant wall application only?

	3+4/LD-01			
34	SHOTCRETE SMOOTH FACE	M2	\$	\$
35	SHOTCRETE ROCK FACE	M2	\$	\$

A12. Yes, this is for secant wall application only.

Q13. Could you please clarify if shoring is required throughout the entire area mentioned in the note, or only in specific locations such as around the concrete wall next to the tennis court and the storm installation beneath it? Also, would it be possible to mark the exact extent of the shoring on the plan for coordination?

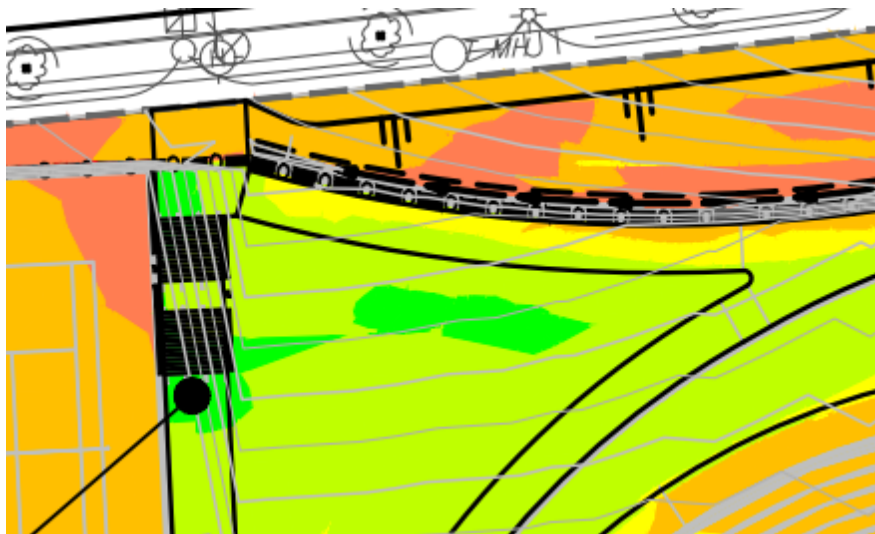
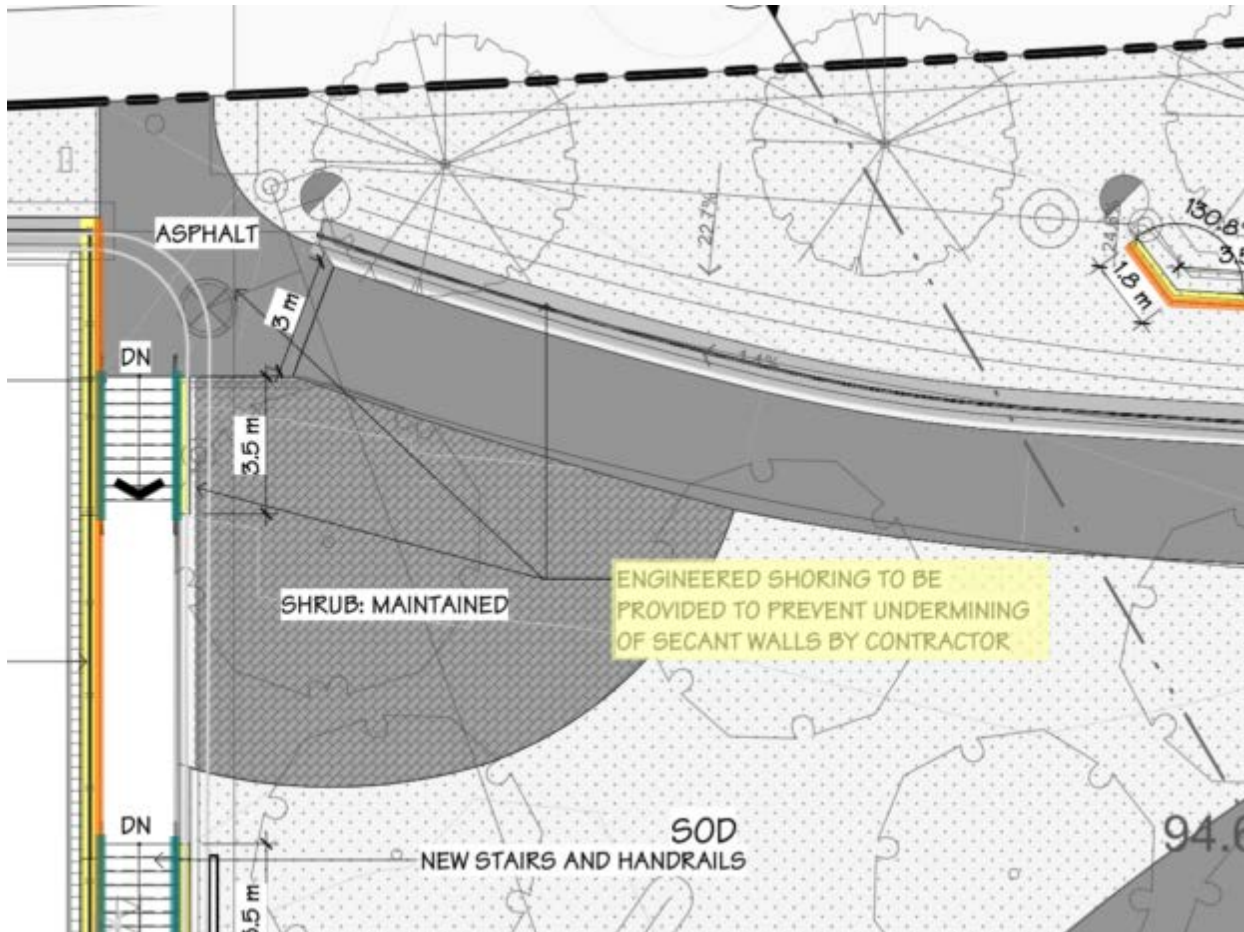

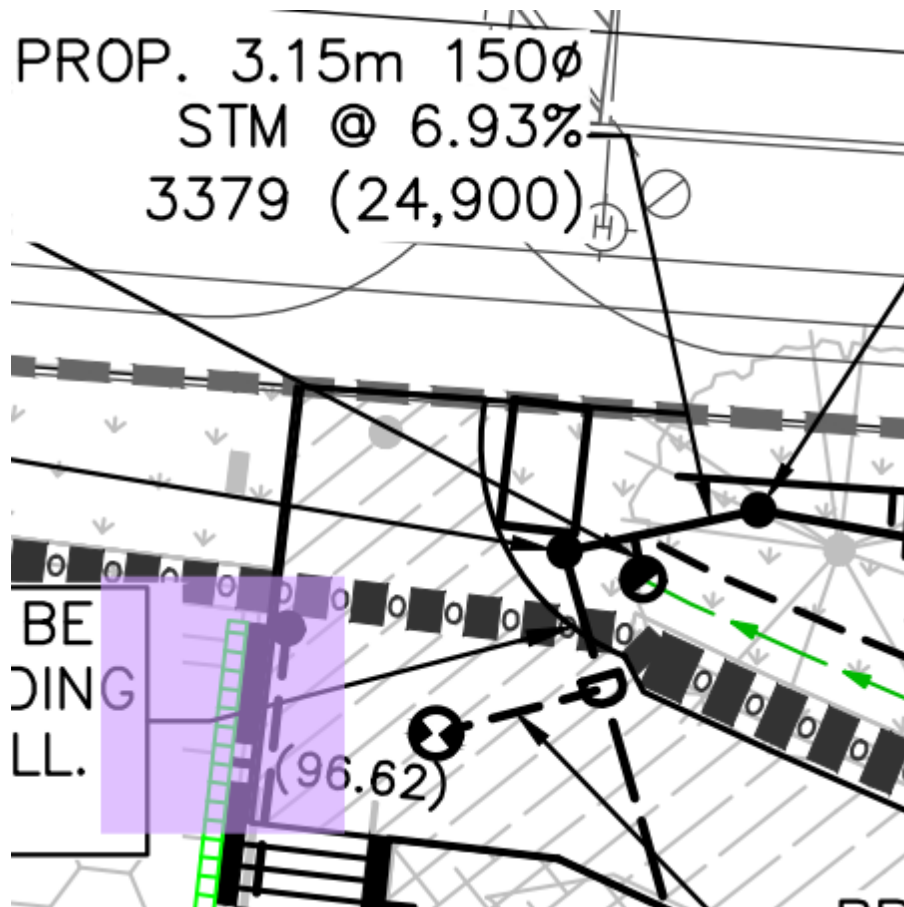

A13. A geotechnical excavation details was included within the March 2025 geotechnical memo. Please review the geotechnical memo and attached drawings. Shoring is not needed in that area; just sloping and engineering review as discussed in the March 2025 memo.

End of Addendum No. 3

Proponents take into account the content of this Addendum in the preparation and submission of the Proposal which will form part of the Contract and should be acknowledged on the Proposal Submission Form.

Upon submitting a Proposal, Proponents are deemed to have received all addenda that are issued and posted on the City's website and considered the information for inclusion in the Proposal submission.

Issued by:

Chris Overes
Senior Procurement Specialist
bid@coquitlam.ca