

# TOWN CENTRE PARK *ENVISION*

## INFORMATION SESSION

1

## WELCOME!

Thank you for coming to the Information Session. Please provide us with your comments and feedback on the proposed land use of Town Centre Park. We will use your input to help us to:

- Plan a future for the park that reflects the community's values; and
- Establish directions and investment priorities for park development for the next 20 years.

This is the second of two public sessions for this project.

## WHAT IS HAPPENING?

We are looking closely at the Town Centre Park and thinking of its future.

The objective is to create a comprehensive plan to guide the future development of Town Centre Park in a way that builds on its current success and accommodates both active and passive uses.

## GOALS FOR TODAY.

1. Share with what we Envision for the park.
2. Show you the Proposed Land Uses for the Park.
3. Share with us your priorities.

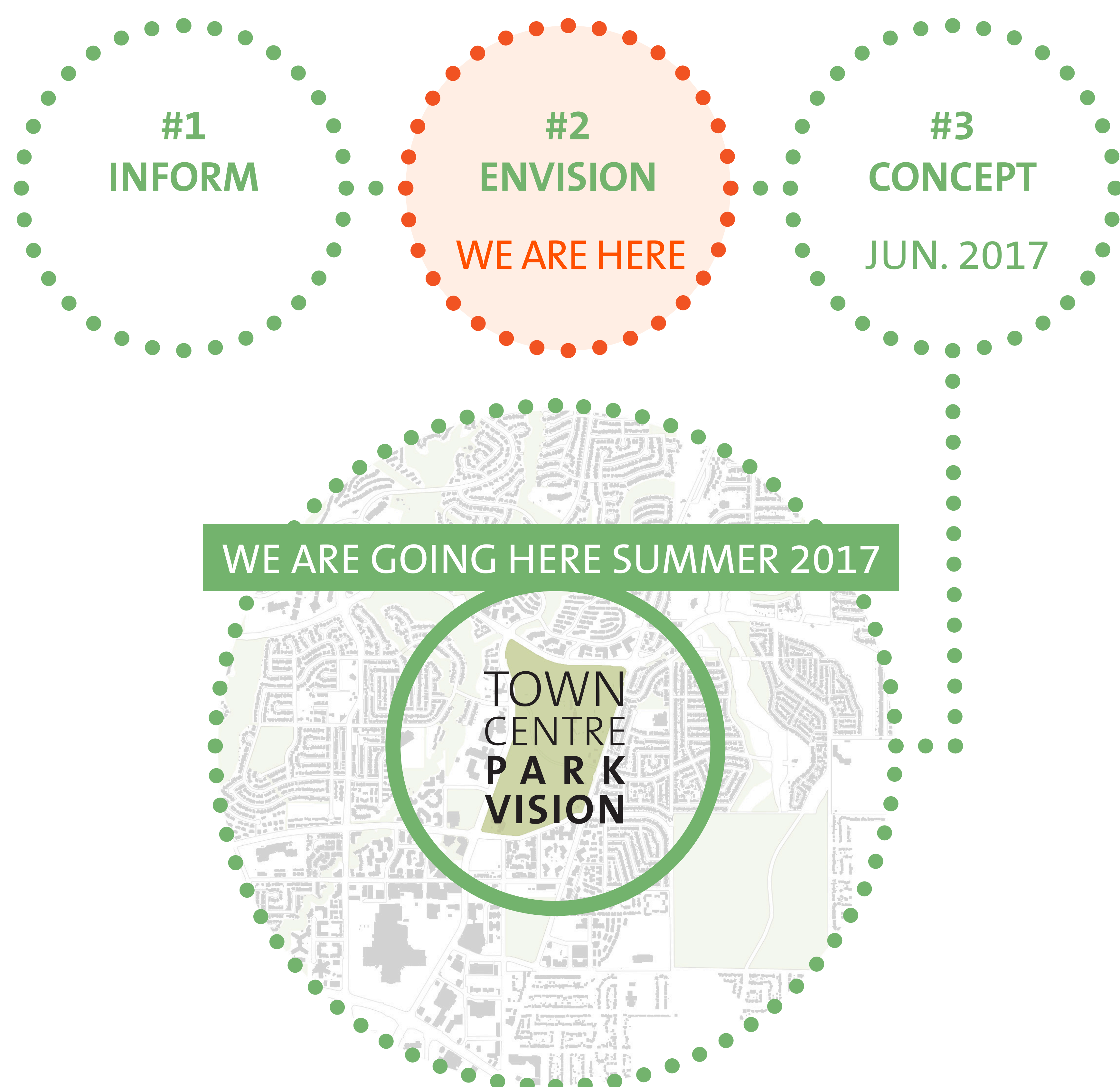

## STAY CONNECTED WITH US!

 [coquitlam.ca/tcpmp](http://coquitlam.ca/tcpmp)

 [parksandconsultation@coquitlam.ca](mailto:parksandconsultation@coquitlam.ca)

 604-927-6300

    CityofCoquitlam





## GUIDING PRINCIPLES

### Key Principles for Town Centre Park Vision

The site analysis, together with the public consultation completed to date, has set the stage for developing guiding principles for the Master Plan. The guiding principles and the resulting Town Centre Park Master Plan, will help inform decisions around improvements to Town Centre Park for the next 20 years.

#### GUIDING PRINCIPLE 1



#### GUIDING PRINCIPLE 2



#### GUIDING PRINCIPLE 3

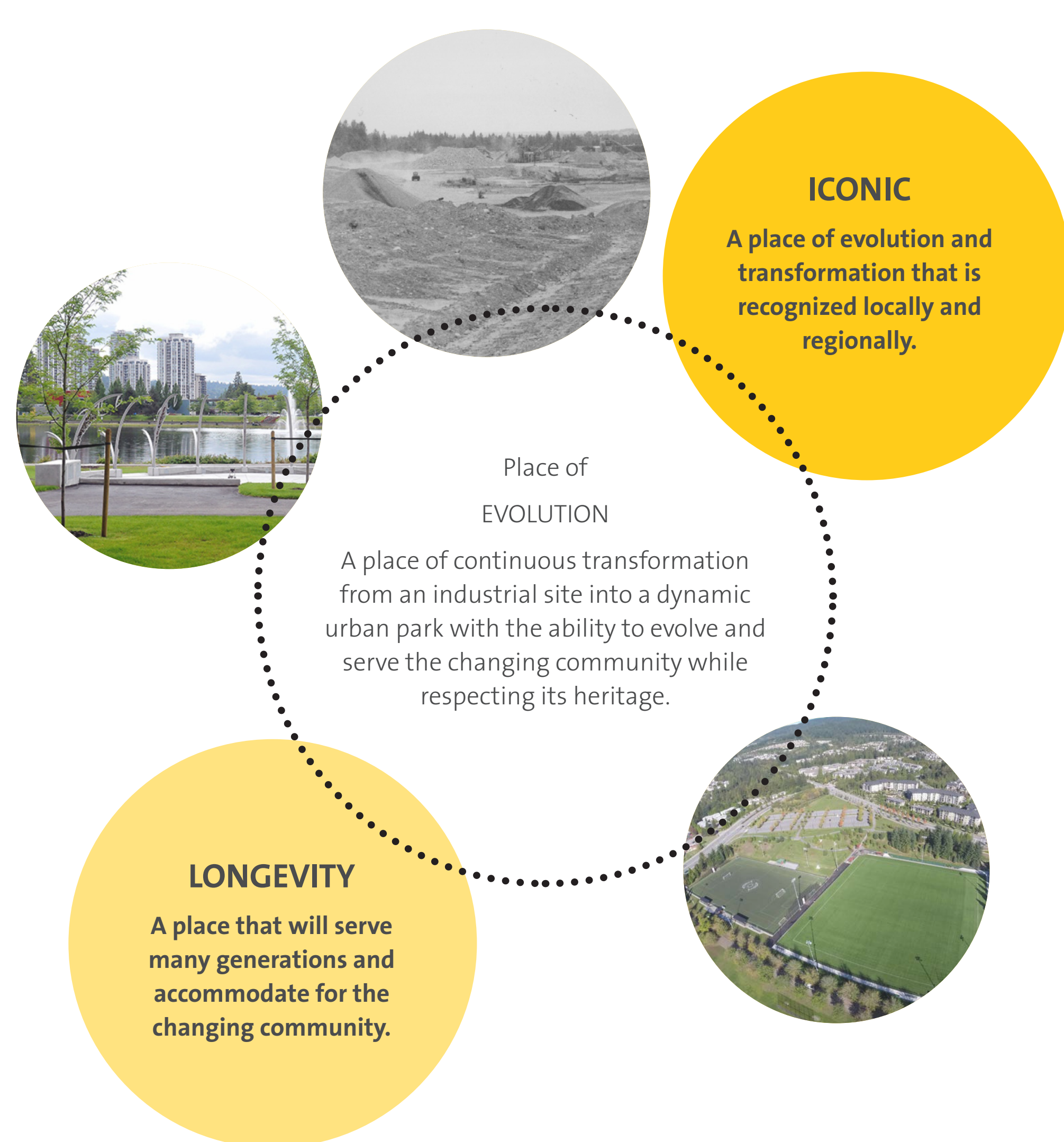

#### GUIDING PRINCIPLE 4



### STAY CONNECTED WITH US!

- [coquitlam.ca/tcpmp](http://coquitlam.ca/tcpmp)
- [parksandconsultation@coquitlam.ca](mailto:parksandconsultation@coquitlam.ca)
- 604-927-6300





# TOWN CENTRE PARK *ENVISION*

## INFORMATION SESSION

### PROPOSED PARK LAND USE PLAN

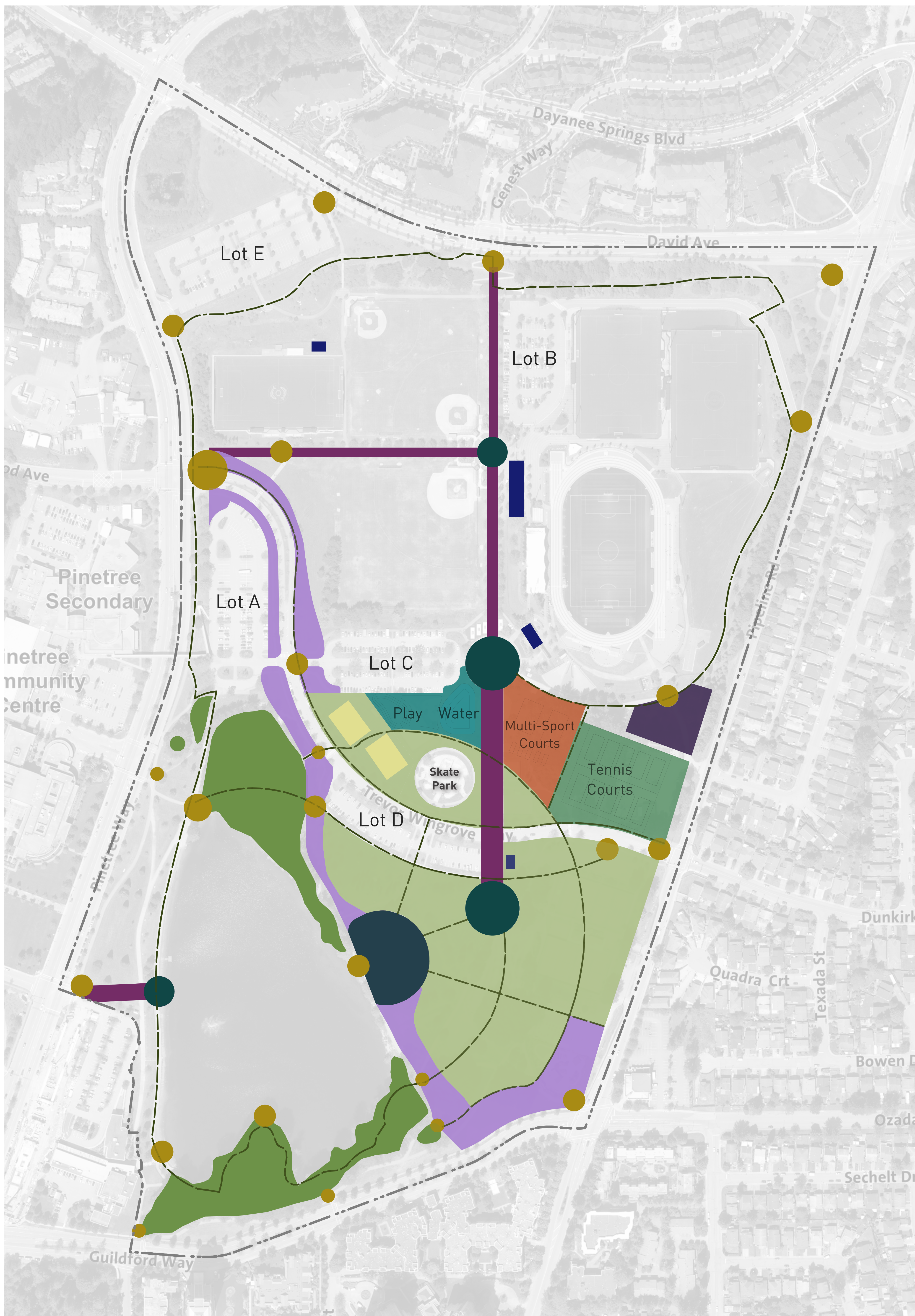

#### LAND USE LEGEND

- OPEN LAWN
- LAKE EDGE IMPROVEMENT AREA
- FACILITY BUILDINGS
- HUBS
- PROMENADES
- PLAY AREA AND SPRAY PAD
- MULTI-SPORT COURTS
- TENNIS COURTS
- SAND VOLLEYBALL COURTS
- NODES AND ENTRIES
- GARDEN WALK
- WORKS YARD
- PRIMARY PARK CIRCULATION

#### STAY CONNECTED WITH US!

- [coquitlam.ca/tcpmp](http://coquitlam.ca/tcpmp)
- [parksandconsultation@coquitlam.ca](mailto:parksandconsultation@coquitlam.ca)
- 604-927-6300





# TOWN CENTRE PARK *ENVISION*

## INFORMATION SESSION

4

### PROPOSED PARK LAND USE FEATURES

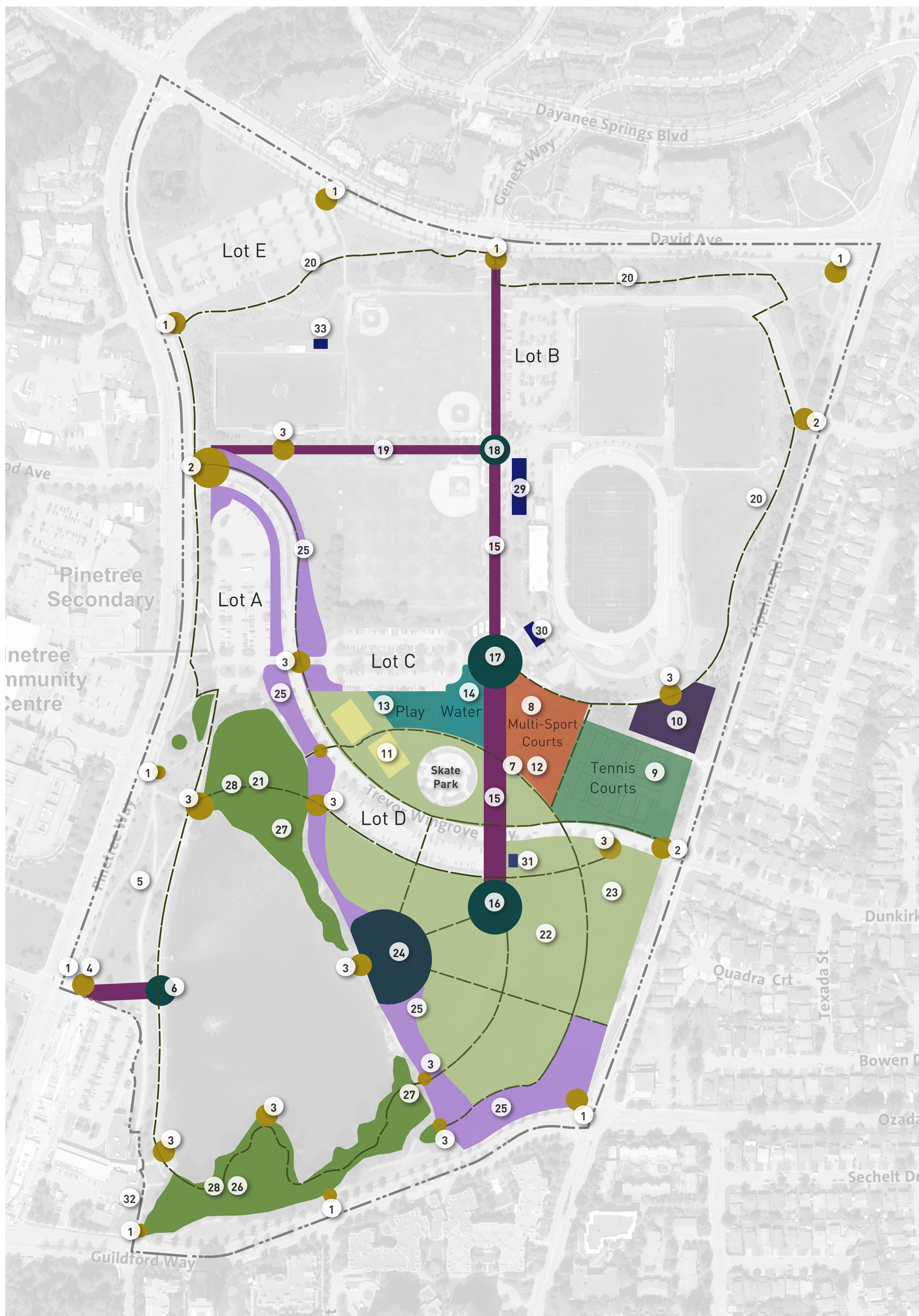

#### STRENGTHEN PARK IDENTITY

Establish entry and nodes hierarchy with a strong signage and wayfinding strategy throughout

1. Create key park pedestrian gateways - improve main and secondary entrances
2. Improve vehicular entrances
3. Create character nodes throughout the park

#### CREATE SENSE OF ARRIVAL

4. Introduce Arrival Plaza north of SkyTrain station with coffee cart
5. Create signature seasonal urban beach destination
6. Provide wharf deck with access to water

#### CREATE THE PARK CORE

7. Relocate hockey and basketball
8. Create new multisport area
9. Add tennis courts (relocated from existing location)
10. Reduce works yard size
11. Reduce volleyball into 4 fields
12. Relocate and add more table tennis

#### CREATE REGIONAL DESTINATION CHILDREN'S PLAY

13. Remove 2 Volleyball courts - expand play area
14. Upgrade and expand to create an Enhanced Spray Pad: more dynamic and appealing for a range of age groups. Relocate the Spray Pad to better integrate with new play and make it usable all year round

#### CONNECT THE PARK

15. Complete Park Promenade North - South: expand existing path + add new south section
16. Create Festival Hub: add new plaza space to the festival lawn area
17. Create Community Hub: convert existing circular planted area into a community gathering place by new concession building
18. Create Sports Hub: convert existing circular space into gathering place by new Fieldhouse
19. Improve East-West axis to sports area
20. Complete Town Centre discovery trail around the park by introducing a lower level path along David Ave.
21. Complete lake loop

#### EXPAND URBAN OASIS

22. Relocate BMX bike park off site - expand festival lawn to BMX location
23. Relocate tennis courts to the north - expand festival lawn to the Pipeline Road edge
24. Focus amenities in relation to the new Town Centre Park Plaza
25. Expand Inspiration Gardens at south-east corner to create an extensive Garden Walk through the park
26. Improve understory along the south area of Lafarge Lake

#### ENHANCE PARK EXPERIENCE AND ACCESSIBILITY

Improve accessibility for all ages and abilities

27. Improve water quality at north area of Lafarge Lake
28. Improve path surfacing along the north and south areas of Lafarge Lake

#### UPGRADE INFRASTRUCTURE

Support large events and gatherings by adding drinking fountains, water hookup and electricity for all hubs and plaza locations

29. Replace existing North Fieldhouse building with new Fieldhouse
30. Replace existing central restroom/concessions building with new Central Fieldhouse building
31. Add new restroom at Festival Hub
32. Add new restroom at access from east side of Evergreen Cultural Centre
33. Add new restroom by Cunning's Field

#### STAY CONNECTED WITH US!

- [coquitlam.ca/tcpmp](http://coquitlam.ca/tcpmp)
- [parksandconsultation@coquitlam.ca](mailto:parksandconsultation@coquitlam.ca)
- 604-927-6300



Coquitlam



# TOWN CENTRE PARK *ENVISION* INFORMATION SESSION

5

## TRANSITION PROCESS SCHEMATIC



### STRENGTHEN PARK IDENTITY

Establish entry and nodes hierarchy with a strong signage and wayfinding strategy throughout

1. Create key park pedestrian gateways - improve main and secondary entrances
2. Improve vehicular entrances
3. Create character nodes throughout the park

### CREATE SENSE OF ARRIVAL

4. Introduce Arrival Plaza north of SkyTrain station with coffee cart
5. Create signature seasonal urban beach destination
6. Provide wharf deck with access to water

### CREATE THE PARK CORE

7. Relocate hockey and basketball
8. Create new multisport area
9. Add tennis courts (relocated from existing location)
10. Reduce works yard size
11. Reduce volleyball into 4 fields
12. Relocate and add more table tennis

### CREATE REGIONAL DESTINATION CHILDREN'S PLAY

13. Remove 2 Volleyball courts - expand play area
14. Upgrade and expand to create an Enhanced Spray Pad: more dynamic and appealing for a range of age groups. Relocate the Spray Pad to better integrate with new play and make it usable all year round

### CONNECT THE PARK

15. Complete Park Promenade North - South: expand existing path + add new south section
16. Create Festival Hub: add new plaza space to the festival lawn area
17. Create Community Hub: convert existing circular planted area into a community gathering place by new concession building
18. Create Sports Hub: convert existing circular space into gathering place by new Fieldhouse
19. Improve East-West axis to sports area
20. Complete Town Centre discovery trail around the park by introducing a lower level path along David Ave.
21. Complete lake loop

### EXPAND URBAN OASIS

22. Relocate BMX bike park off site - expand festival lawn to BMX location
23. Relocate tennis courts to the north - expand festival lawn to the Pipeline Road edge
24. Focus amenities in relation to the new Town Centre Park Plaza
25. Expand Inspiration Gardens at south-east corner to create an extensive Garden Walk through the park
26. Improve understory along the south area of Lafarge Lake

### ENHANCE PARK EXPERIENCE AND ACCESSIBILITY

Improve accessibility for all ages and abilities

27. Improve water quality at north area of Lafarge Lake
28. Improve path surfacing along the north and south areas of Lafarge Lake

### UPGRADE INFRASTRUCTURE

Support large events and gatherings by adding drinking fountains, water hookup and electricity for all hubs and plaza locations

29. Replace existing North Fieldhouse building with new Fieldhouse
30. Replace existing central restroom/concessions building with new Central Fieldhouse building
31. Add new restroom at Festival Hub
32. Add new restroom at access from east side of Evergreen Cultural Centre
33. Add new restroom by Cunning's Field

### STAY CONNECTED WITH US!

- [coquitlam.ca/tcpmp](http://coquitlam.ca/tcpmp)
- [parksandconsultation@coquitlam.ca](mailto:parksandconsultation@coquitlam.ca)
- 604-927-6300



Coquitlam



# TOWN CENTRE PARK *ENVISION* INFORMATION SESSION

6

## FACILITIES

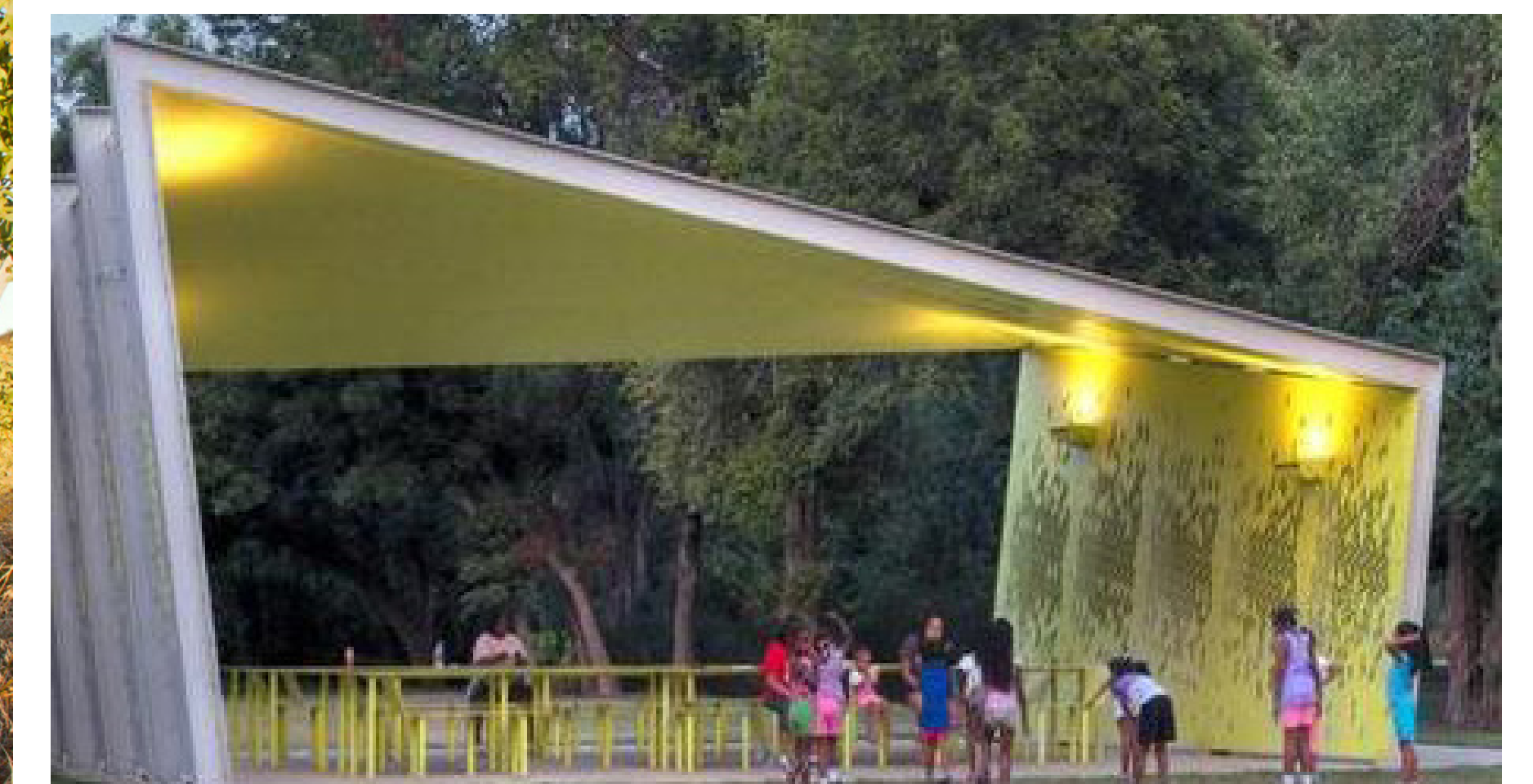

## FACILITIES

Facilities are important elements of the Park that help define it's identity and character and enhance the experience and comfort of visitors.

### A. Fieldhouses

- Locate a Central Fieldhouse at the Festival Hub (or close by) at the core of the park, as well as a North Fieldhouse to serve the sports programming in the north.
- Fieldhouses shall be reflective of the park identity in form, colour and function
- Fieldhouses shall be sited to become integrated into the overall park programming

### B. Park Facilities

- Incorporate sports change room areas into the Park structures adjacent to fields and courts
- Express park identity in form, colour and function of sports change areas
- Integrate park operations building into the park so they are reflective of the park identity in form, colour and function

### C. Parking Areas

- Significant tree canopy to be incorporated into parking area when possible
- Parking area design to encourage multiple programming opportunities. This includes elements such as: parking, storm water management, markets, and festivals.

## STAY CONNECTED WITH US!



[coquitlam.ca/tcpmp](http://coquitlam.ca/tcpmp)



[parksandconsultation@coquitlam.ca](mailto:parksandconsultation@coquitlam.ca)



604-927-6300



CityofCoquitlam

Coquitlam



# TOWN CENTRE PARK *ENVISION*

## INFORMATION SESSION

7

### RESTROOMS + SERVICES



### ESTABLISH RESTROOMS

- Locate restrooms around busiest locations
- Size restrooms to accommodate events
- Most of the park is within a 3 minute (240m) walk from restrooms.

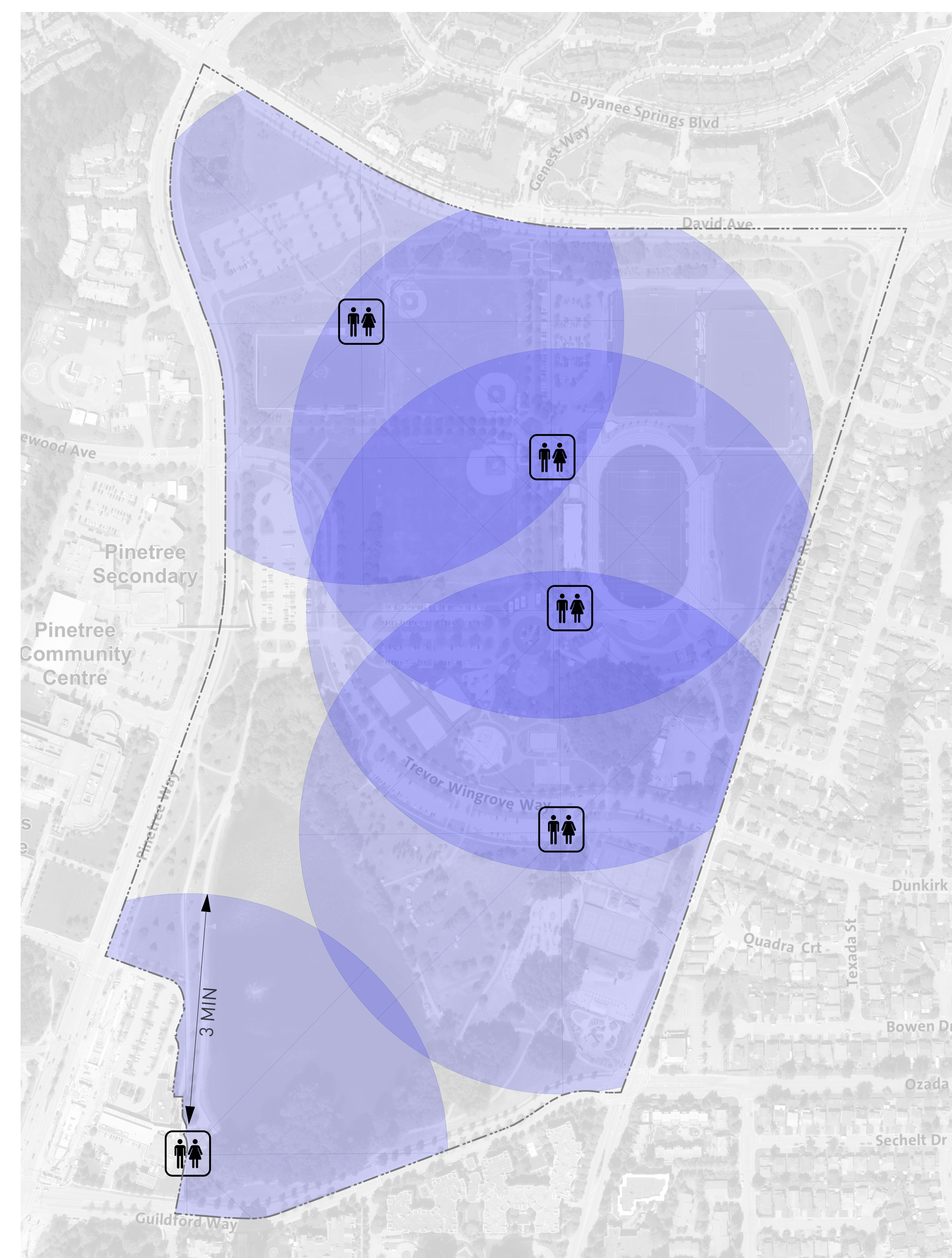

CAFE

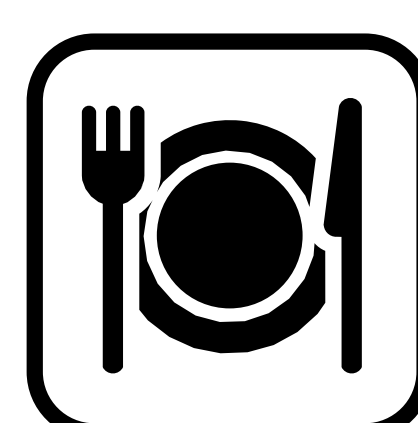

RESTAURANT

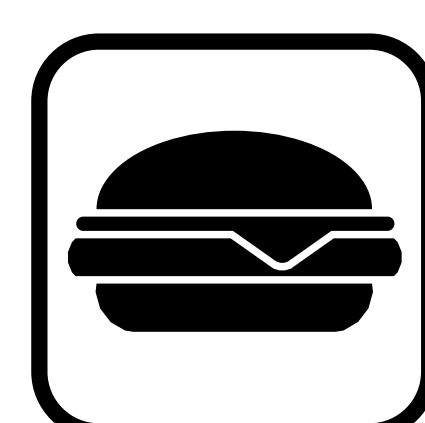

CONCESSION

### ESTABLISH FOOD SERVICES

- Provide cafe close to SkyTrain station
- Locate upgraded concessions at Central Fieldhouse
- Locate restaurant at North Fieldhouse
- Investigate potential destination restaurant at Innovation Centre as part of planning for the future of this facility.

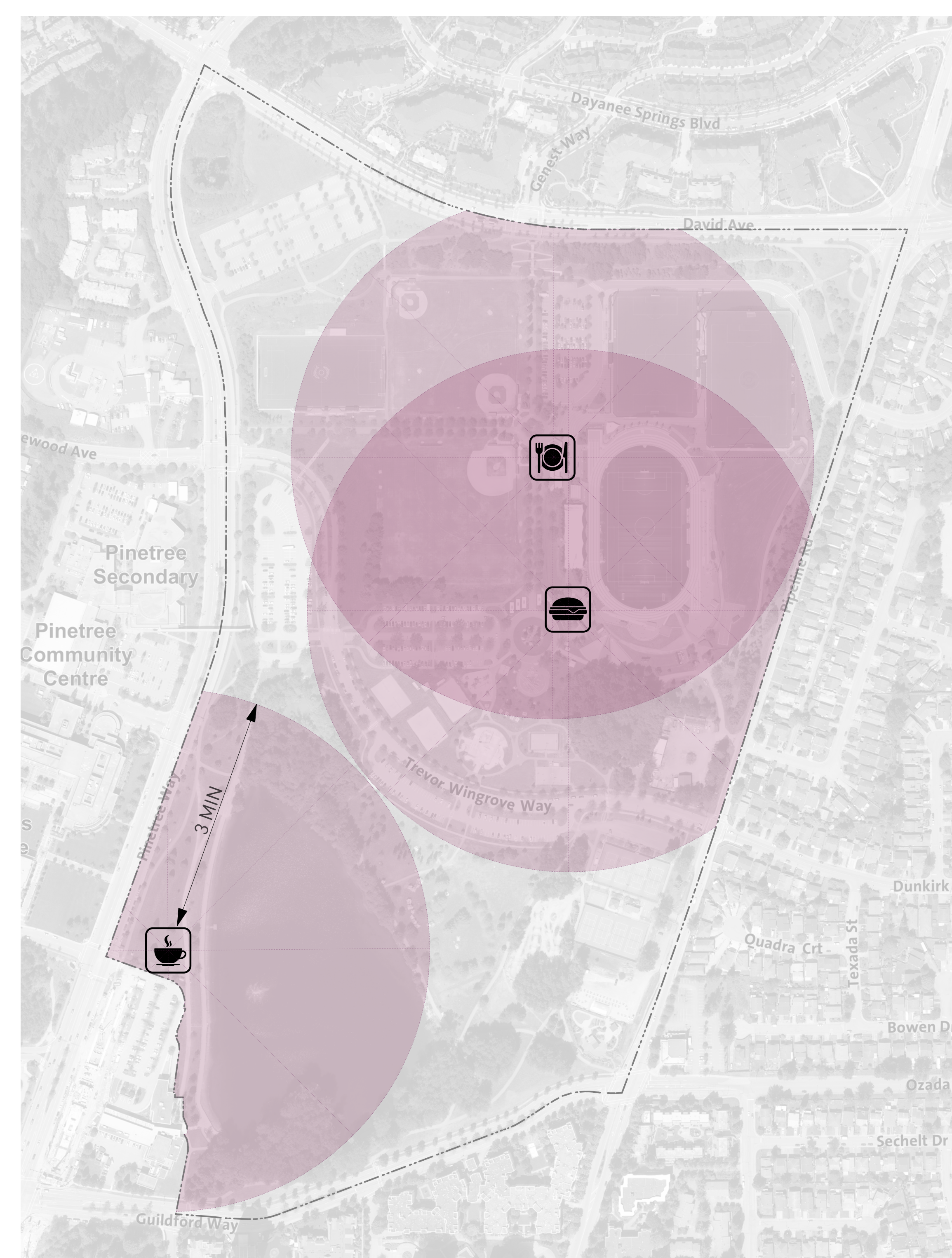

### STAY CONNECTED WITH US!



[coquitlam.ca/tcpmp](http://coquitlam.ca/tcpmp)



[parksandconsultation@coquitlam.ca](mailto:parksandconsultation@coquitlam.ca)



604-927-6300



CityofCoquitlam

Coquitlam



# TOWN CENTRE PARK *ENVISION* INFORMATION SESSION

8

## GREEN COMMONS

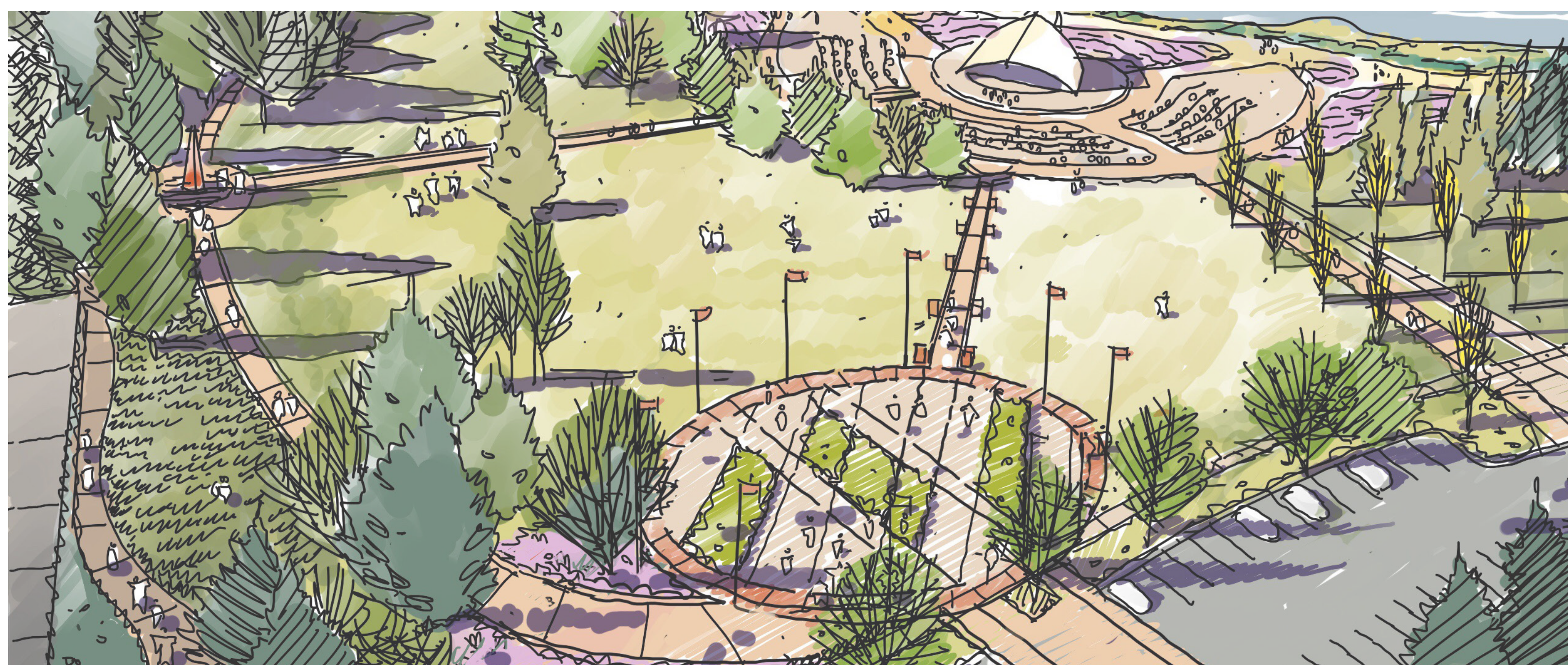

## GREEN COMMONS: PASSIVE RECREATION ZONE

### A. Expand Open Lawn Area

The Green Commons is given more space to provide room for new trees and plantings as respite from hard surfaces and the cityscape. The expanded lawn provides a larger, more flexible area for gatherings and events, and is secured as green space for passive recreation in the heart of Coquitlam.

- Festival Lawn expands north-eastward into existing BMX park to make more passive lawn available to variety of park program elements
- Improved pedestrian circulation to and from Amphitheatre area
- The appeal and comfort of the Green Commons is retained and enhanced
- More space and facilities are provided for everyday passive recreation and picnicking
- Improved areas to provide support for large festival events such as Canada Day celebration
- More accessible pathways
- Create Festival Hub as an urban place for gathering and events

### B. Enhance the Lake Edges

The Lafarge Lake area is one of the most loved areas of the park. It's a visual attraction but also a sanctuary and a passive use area for the citizens of Coquitlam.

- Introduce "on the water" areas such as decks and wharfs for better access and connection to the water
- Create one or more dedicated locations for fishing (from a wharf) to decrease user conflicts on trails
- Enhance the health and quality of the forested areas surrounding the lake
- Provide wider and universally accessible paths around the lake
- Complete the accessible pathway loop (provide a connection through the north area)

### C. Create a Sense of Arrival

Addition of a new SkyTrain station creates a new dynamic sense to the park and provides a strong anchor to the south-west corner within the Green Commons. To emphasize the importance of this pedestrian gateway, a few key shifts are being proposed:

- Extend the SkyTrain station plaza into the new Arrival Plaza to create a gateway to the park
- Introduce a strong visual presence in the park, that is recognizable and visible from the SkyTrain platform
- Consider signage elements of appropriate size and scale visible from farther distances and higher speeds of moving train and vehicles
- Enhance pedestrian arrival points with planting as well as clear and accessible pathways

## STAY CONNECTED WITH US!

 [coquitlam.ca/tcpmp](https://coquitlam.ca/tcpmp)

 [parksandconsultation@coquitlam.ca](mailto:parksandconsultation@coquitlam.ca)

 604-927-6300

    CityofCoquitlam

**Coquitlam**



# TOWN CENTRE PARK *ENVISION* INFORMATION SESSION

9

## GREEN COMMONS: PASSIVE RECREATION ZONE

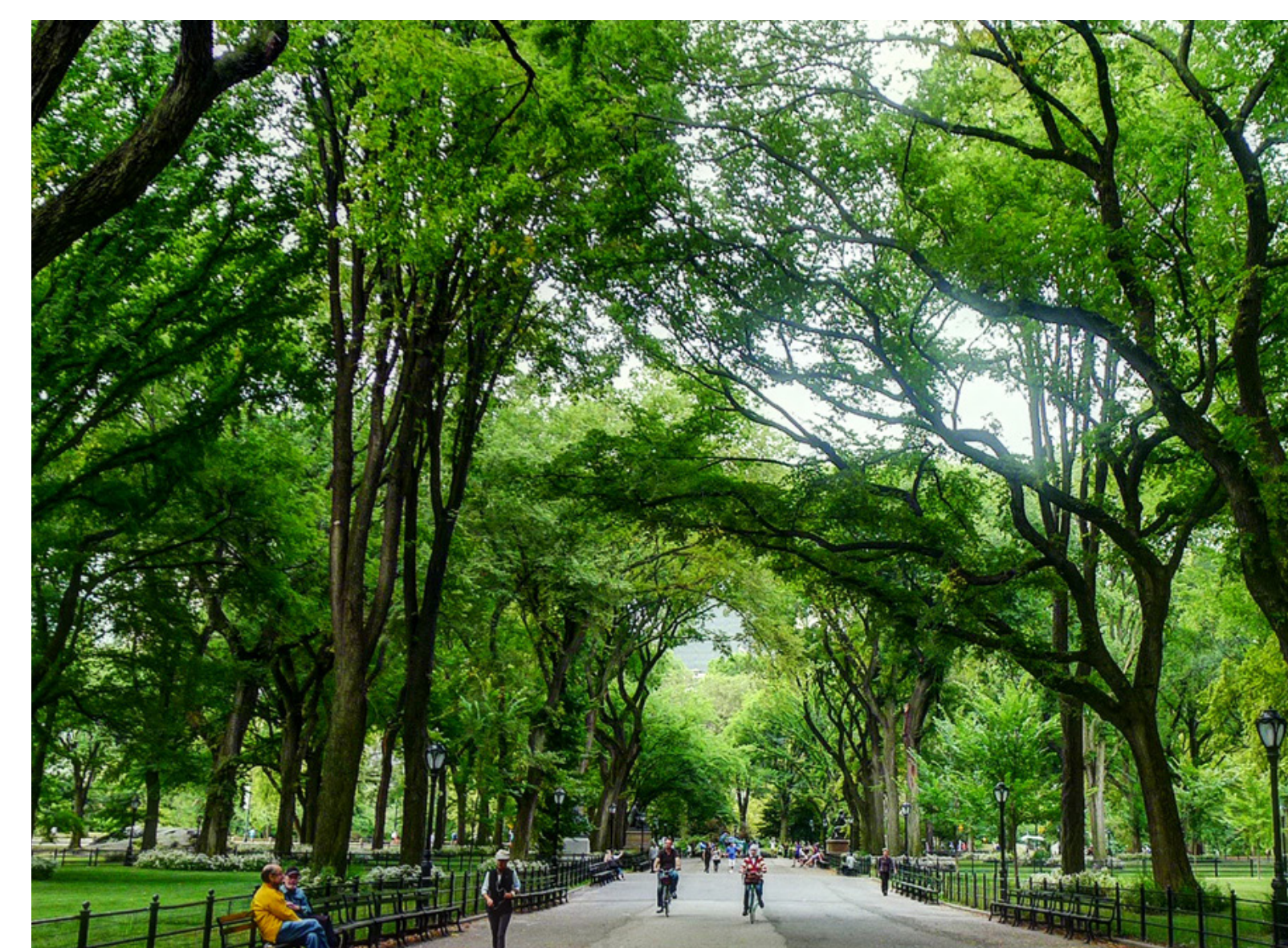
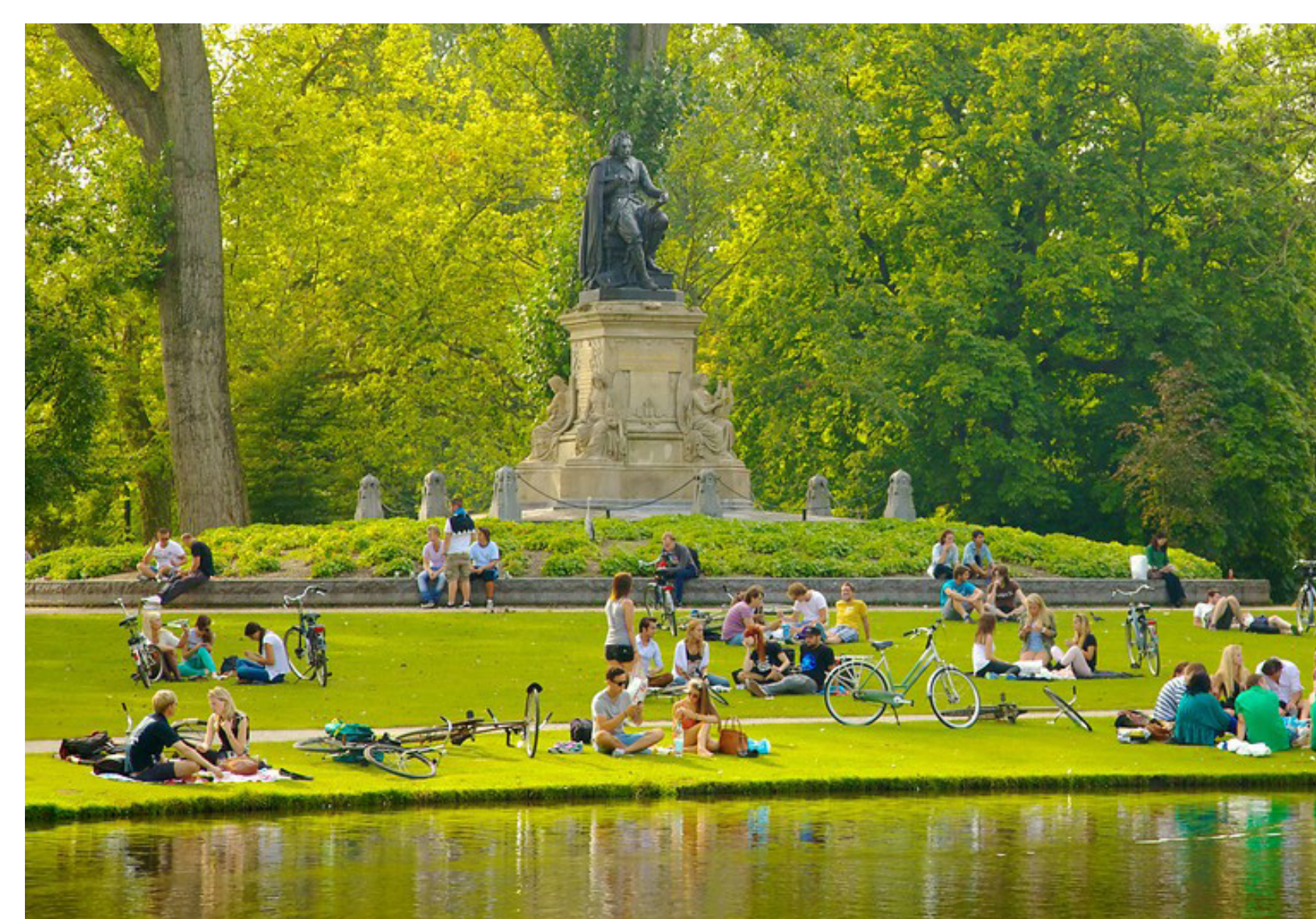
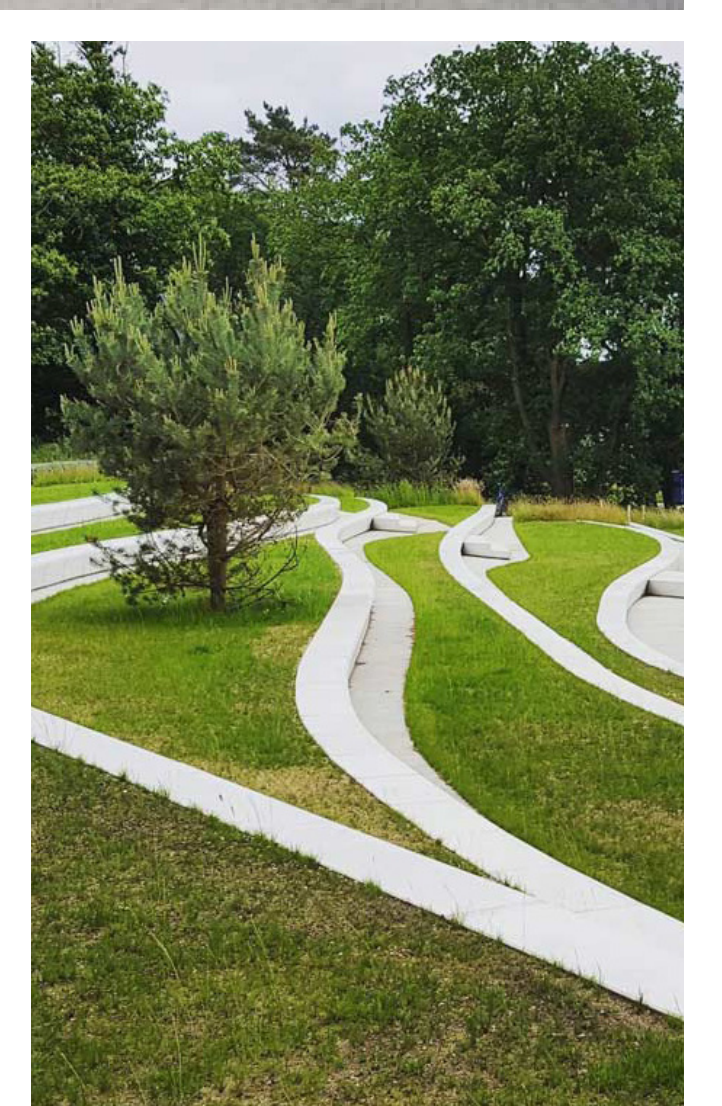
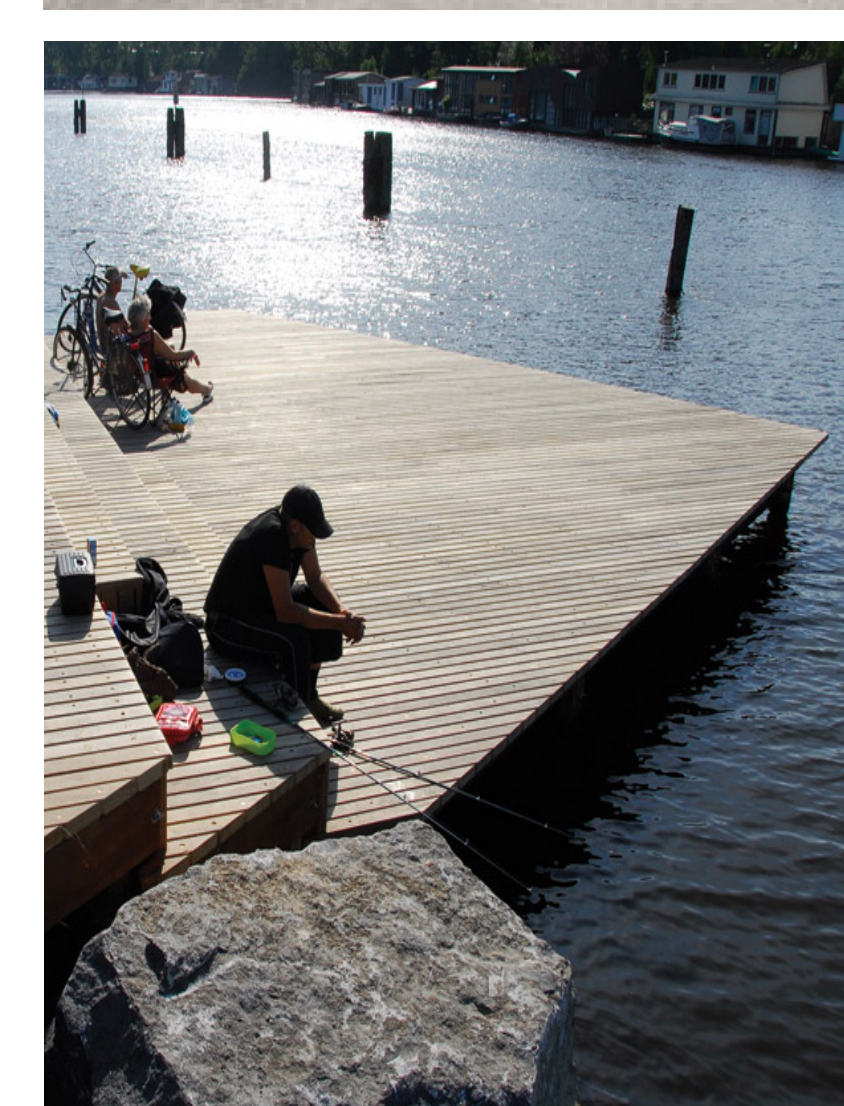
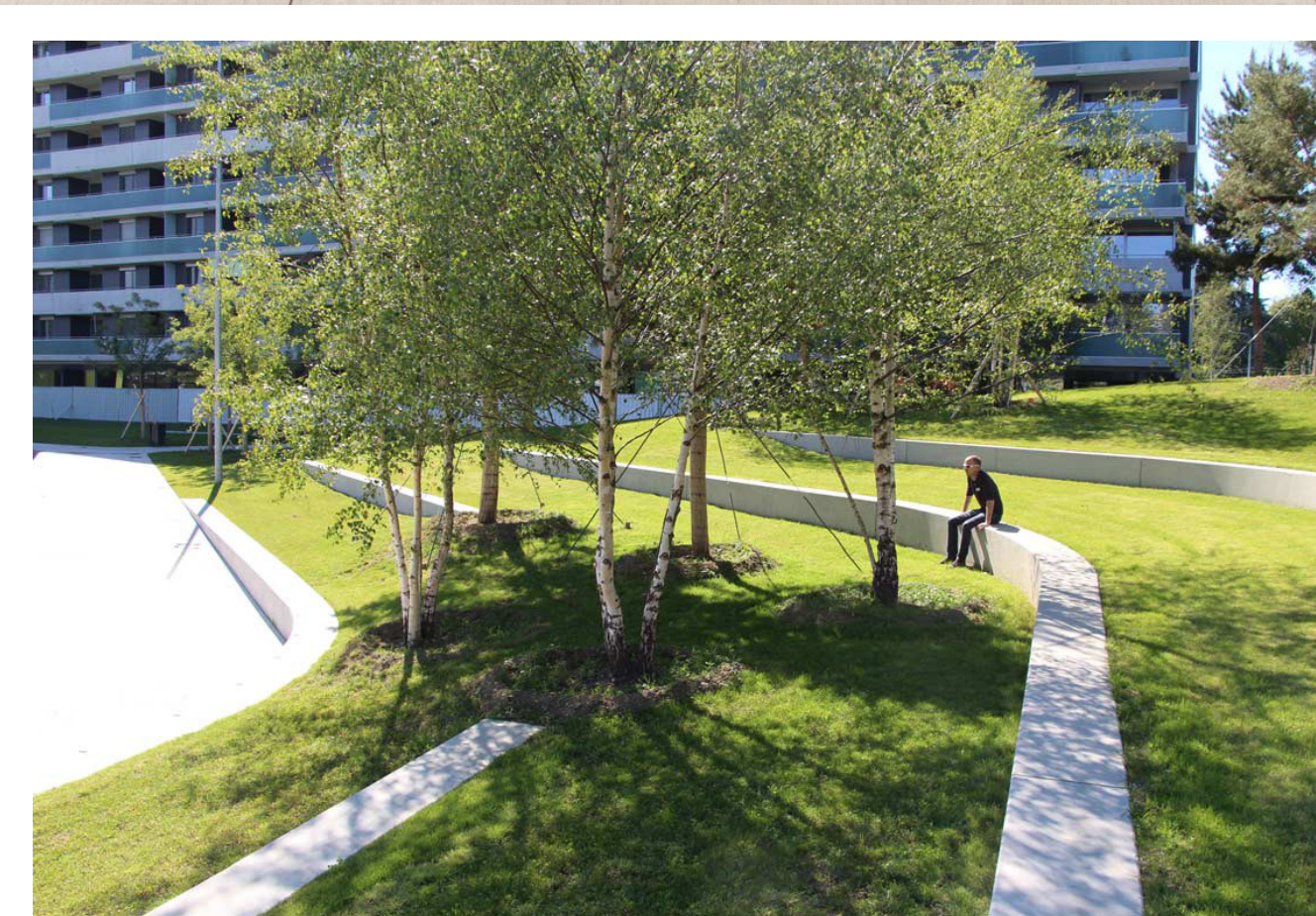
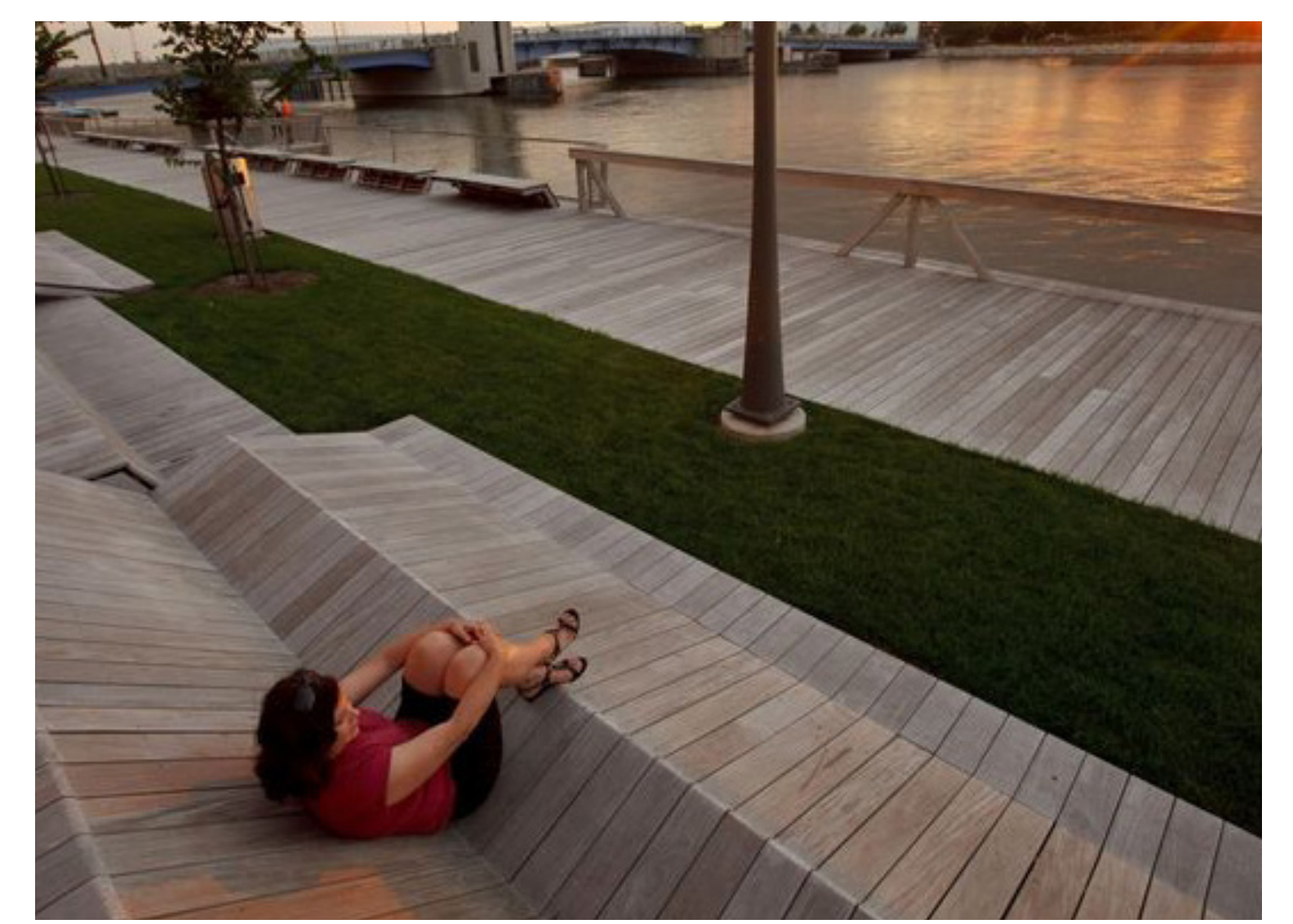
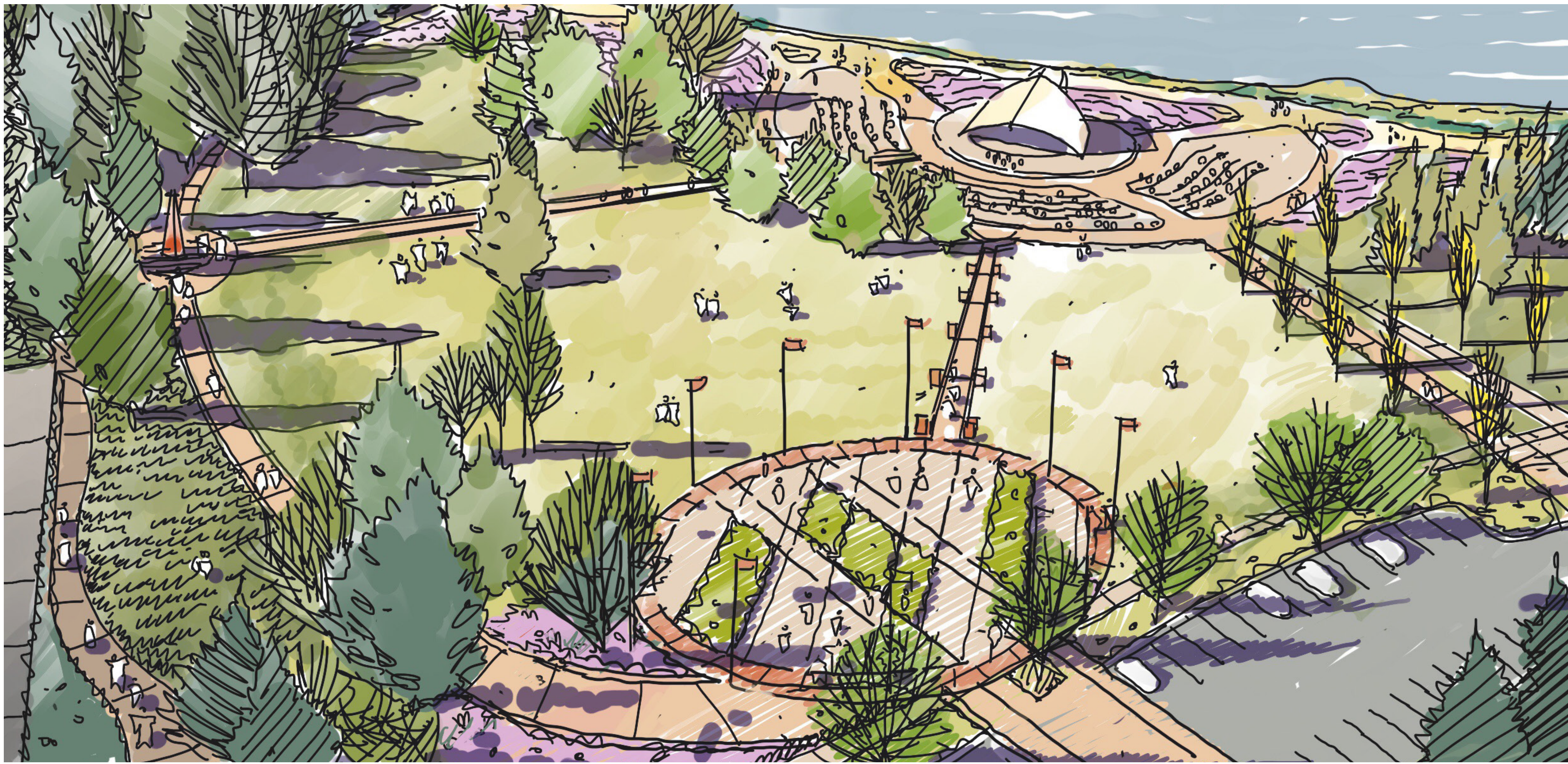

STAY CONNECTED WITH US!



[coquitlam.ca/tcpmp](http://coquitlam.ca/tcpmp)



[parksandconsultation@coquitlam.ca](mailto:parksandconsultation@coquitlam.ca)



604-927-6300



CityofCoquitlam

Coquitlam



# TOWN CENTRE PARK *ENVISION*

## INFORMATION SESSION

10

### GARDEN WALK



## GARDEN WALK

### A. Horticultural Expression

The Garden Walk is a ribbon that weaves the site together and creates a strong park identity through horticultural expression.

- Create the feeling of a lush, green oasis within the urban
- Consider feature trees to create horticultural identity through the park
- Low maintenance plants to provide backbone planting accented by annuals and feature gardens

### B. Seasonal Interest

- Four seasons planting provide horticultural interest all year
- Pockets of annuals accent a framework of perennial plantings

### C. Ecosystem services

- Provide trees to shade in key locations
- Promote biodiversity and pollinator plants throughout park

### GREEN INFRASTRUCTURE AND HABITAT



## GREEN INFRASTRUCTURE AND HABITAT

### A. Stormwater Management

- Retain existing detention pool at north west corner of the park
- Paving materials to be permeable when possible
- Rainwater shall be celebrated by using a variety of plant material pallets

### B. Sustainable Materials

- Permeable surfaces to be utilized when applicable
- Locally sourced materials to be used where possible

### C. Habitat Enhancement

- Retain and enhance green areas
- Examine the relationship between human use and existing lake wildlife
- Provide plantings to encourage pollinator species
- Provide plantings to encourage bird population
- A diverse native plant palette is to be used when possible
- Seasonal variation of plantings to be utilized

### STAY CONNECTED WITH US!



[coquitlam.ca/tcpmp](https://coquitlam.ca/tcpmp)



[parksandconsultation@coquitlam.ca](mailto:parksandconsultation@coquitlam.ca)



604-927-6300



CityofCoquitlam

Coquitlam





## PARK CORE: ACTIVE RECREATION ZONE

### A. Reinvent play areas

The central area of Town Centre Park is proposed to have a re-fresh, and is re-envisioned to become the 'Heart of the Park'. With more useful space and improved integration elements, a defined Park Core is established. Numerous play options are combined in an integrated, more urban approach, in order to become an active place for everyday uses and for large number of people at the same time.

- Improve the visual and physical integration of play elements through use of cohesive paving treatments
- Upgrade and expand to create an Enhanced Spray Pad: more dynamic and appealing for a range of age groups. Relocate Spray Pad to better integrate with new play and make it usable all year round
- Rethink children's play to include interesting land forms and creative play programming
- Relocation of Tennis Courts to the Park Core
- Retain existing elements that are in good condition where possible, such as the Skatepark and four of six Sand Volleyball Courts
- Establish a Community Hub as an urban hub for gathering and socializing
- Improved pedestrian flow and movement between elements

### B. Blur the edges

The overall proposed strategy is to mix visitors as much as possible in this zone while retaining enough distinction to create defined boundaries at the same time. This core area has been divided into larger area of multi-sport play with courts and additional opportunities for flexible play, volleyball courts, as well and various play zones for younger users. Some of the play elements such as ping pong and outdoor fitness equipment have also been proposed within this space.

- Park identity is expressed strongly and playfully within the colourful, dynamic space
- Defined zones, with a priority on user safety and enjoyment, are integrated visually to create a lively sense of connection
- Decorative paving as the dominant connective element that blends the distinct areas into one cohesive area with plantings complimenting and softening the space
- A mix of plazas, play, and sports elements for users of all ages
- Flexibility embedded into spaces that support multiple uses
- Spaces and uses have a clear hierarchy and organization to improve wayfinding

## STAY CONNECTED WITH US!



[coquitlam.ca/tcpmp](https://coquitlam.ca/tcpmp)



[parksandconsultation@coquitlam.ca](mailto:parksandconsultation@coquitlam.ca)



604-927-6300



CityofCoquitlam

Coquitlam



# TOWN CENTRE PARK *ENVISION* INFORMATION SESSION

12

## PARK CORE: ACTIVE RECREATION ZONE

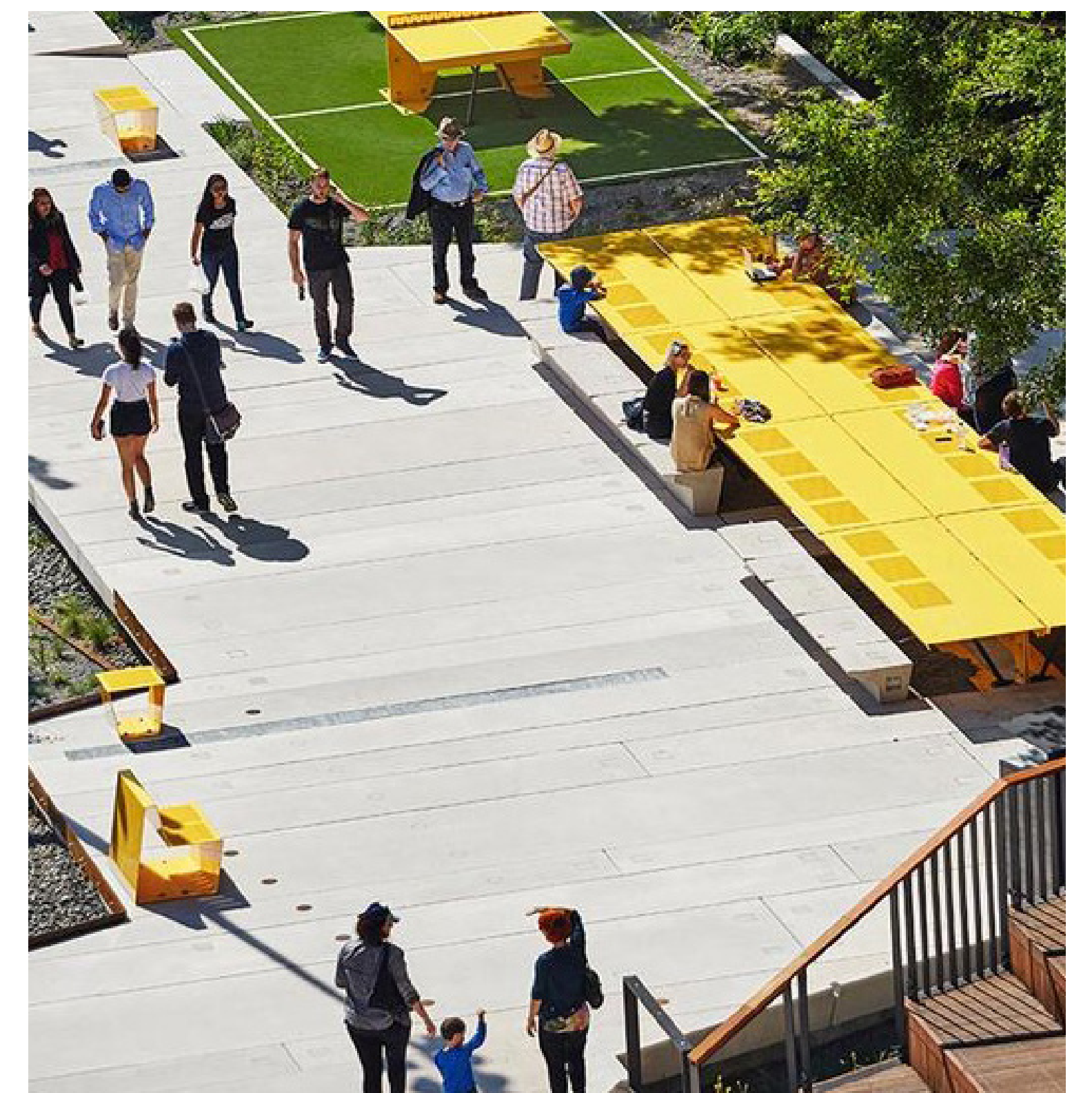
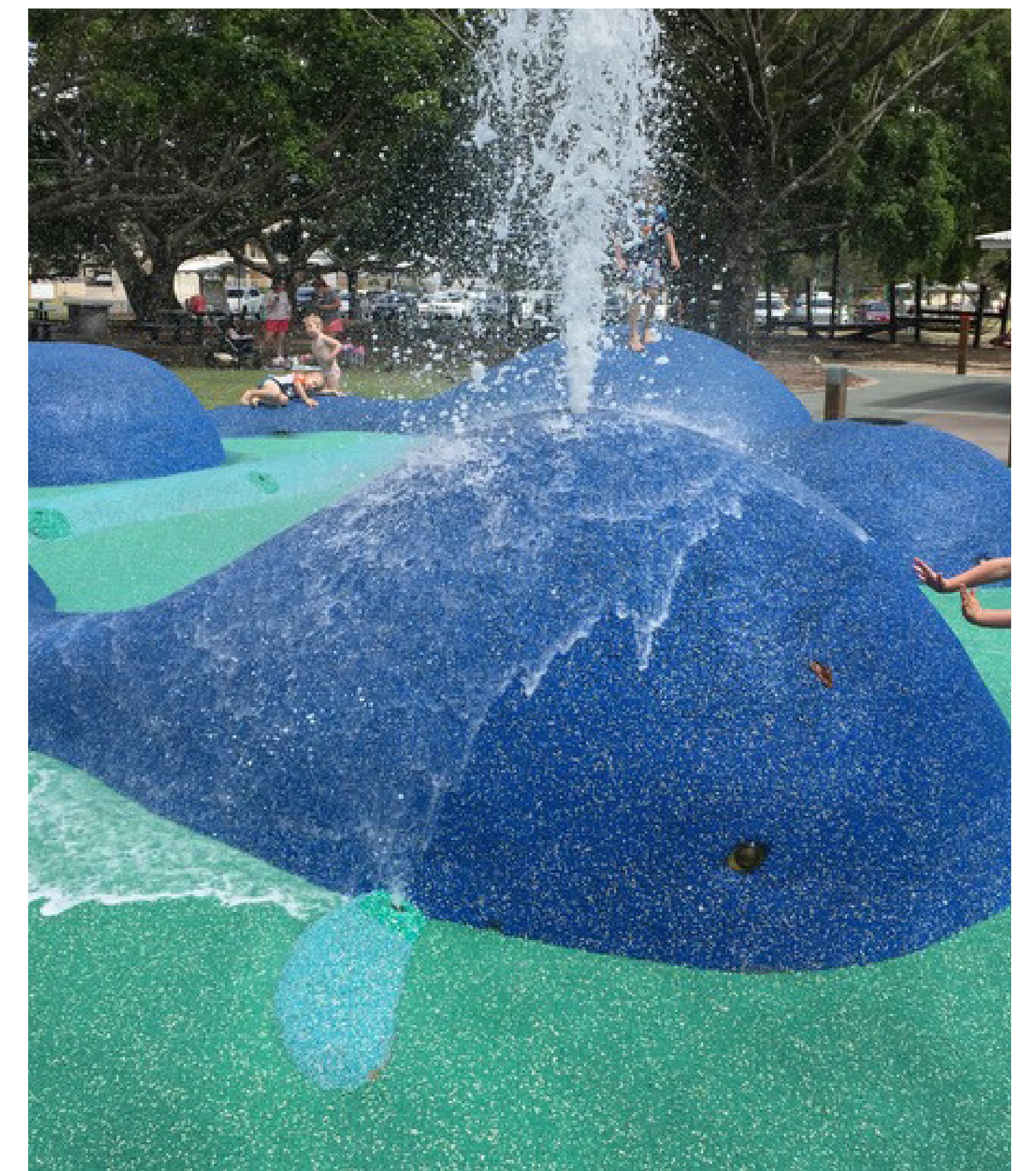
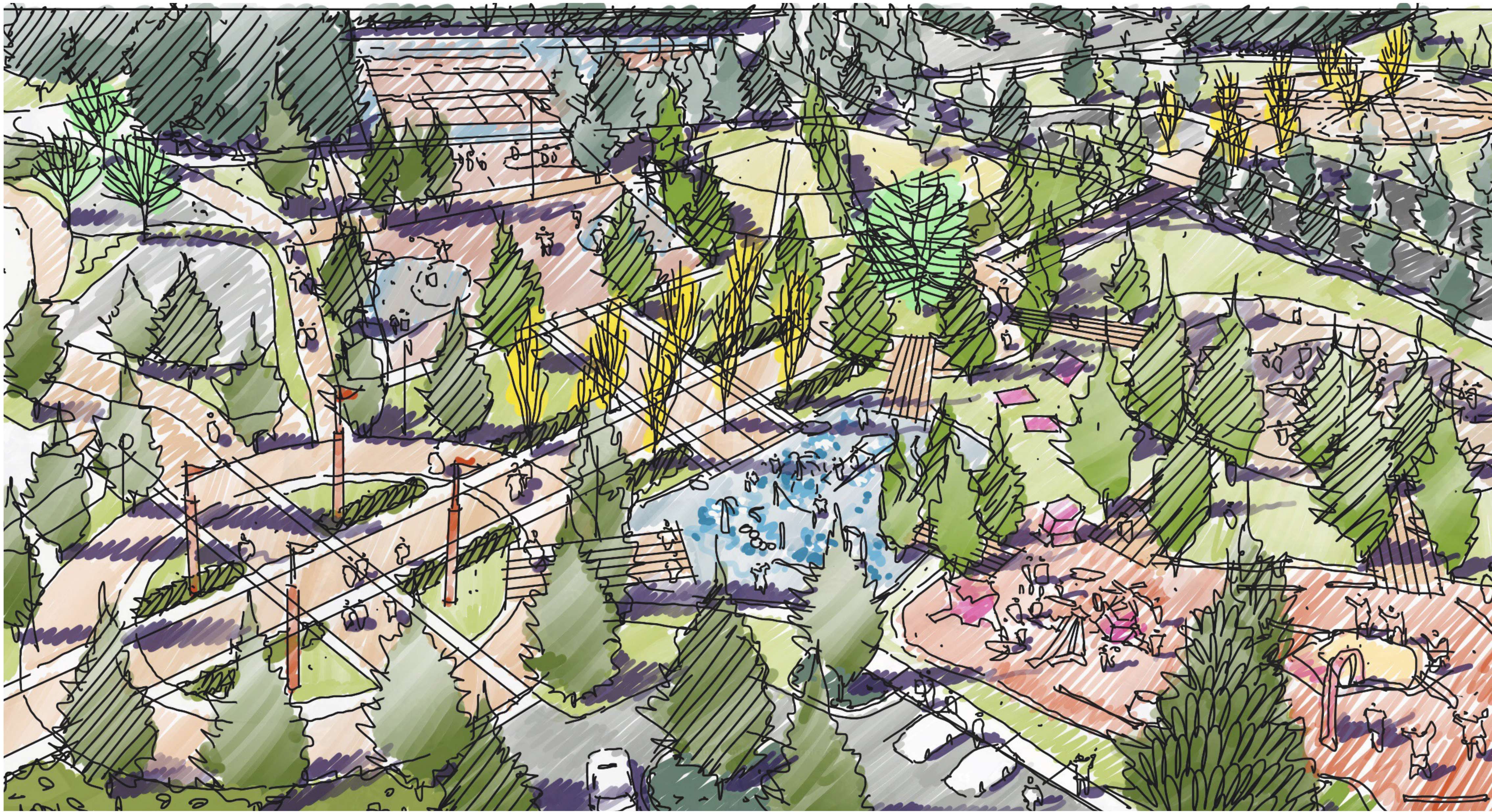

STAY CONNECTED WITH US!

 [coquitlam.ca/tcpmp](http://coquitlam.ca/tcpmp)

 [parksandconsultation@coquitlam.ca](mailto:parksandconsultation@coquitlam.ca)

 604-927-6300

    CityofCoquitlam

Coquitlam



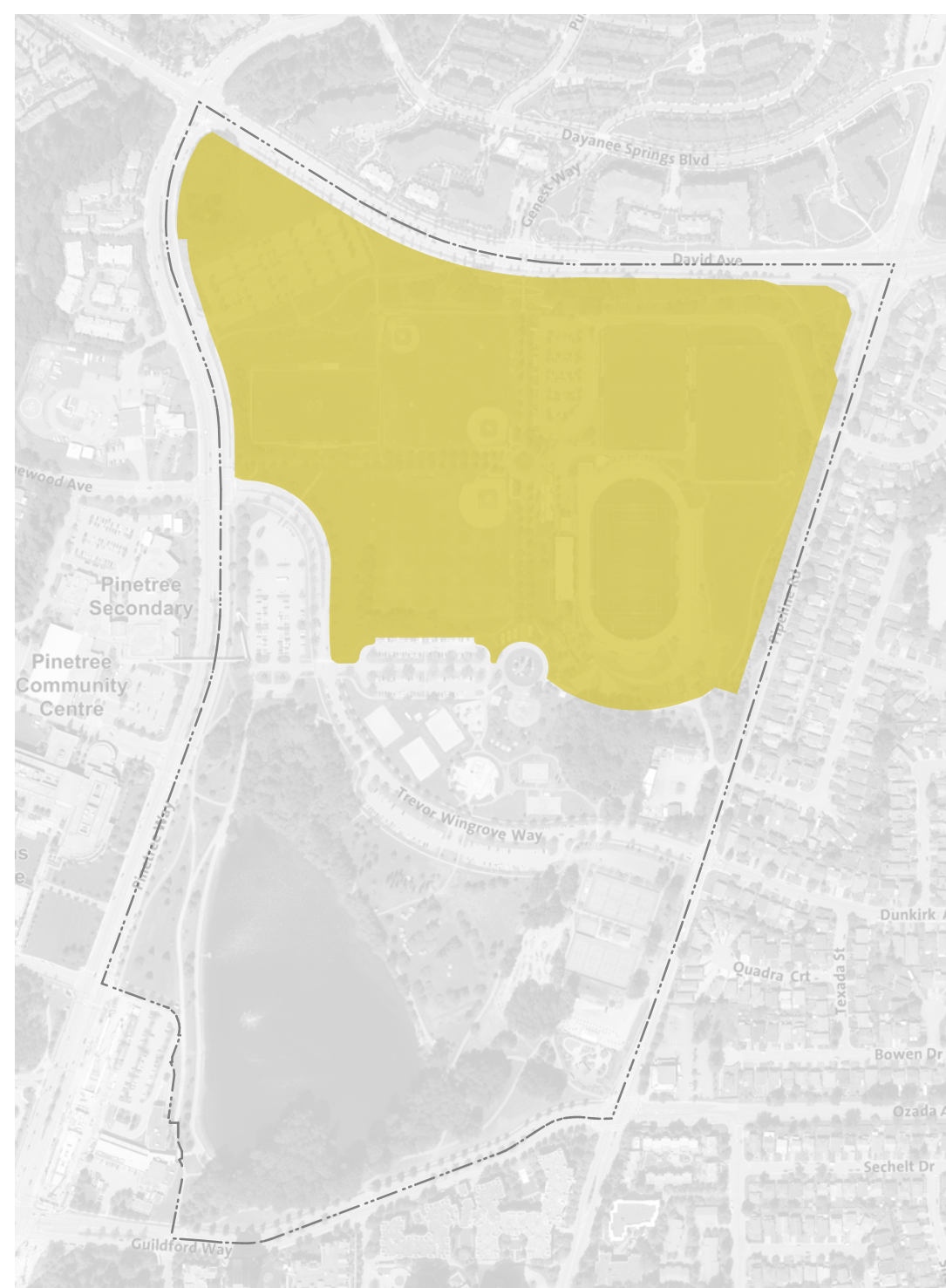

## SPORTS COMMONS: PREMIER SPORTS ZONE

The Sports Commons area features high-quality fields, is well organized, and is already clearly defined. Key improvements moving forward will be focused on maintenance, facilities upgrades, and minor improvements, rather than implementing big moves in this zone.

### A. DEFINE a SPORTS HUB

Creating a plaza that acts as a hub for the Sports Commons will allow for a concentration of facilities in a centralized location to serve sports and other large scale events. By defining a central hub, an opportunity to gather to support sports community is embedded into the otherwise undefined areas around the facilities. Proposed improvements to the Sports Commons are:

- Re-imagine node on central axis between the two baseball diamonds as an open plaza “Sports Hub” with improved facilities to serve the surrounding fields
- Central north-south axis becomes the Park Promenade, an axis with an urban character that connects to the Park Core.

### B. Maintain Great Quality Sports Facilities

The success of the much loved existing sport fields means there is little work to be done in this area. As the lifecycle of sports fields and facilities near their end, opportunities to integrate the Town Centre Park identity through colours and signage should be considered. Proposed improvements to the Sports Commons are to:

- Provide additional washrooms and changing facilities, as well as a new Field House
- Improve building quality and build in flexibility for future growth and change
- Incorporate Town Centre Park visual identity into future improvements

### C. Integrate Alternative Uses

Plan for the layering of alternative uses into the Sports Commons, primarily along the promenade that connects to the Park Core. Proposed improvements to the Sports Commons are to:

- Enhance and open the north-south axis through the Sports Commons, creating a place for temporary events such as farmers markets, festivals, fundraising events, and fairs.
- Introduce a dramatic element to emphasize the axial connection through the park, such as feature seating element.

## STAY CONNECTED WITH US!



[coquitlam.ca/tcpmp](https://coquitlam.ca/tcpmp)



[parksandconsultation@coquitlam.ca](mailto:parksandconsultation@coquitlam.ca)



604-927-6300



CityofCoquitlam

Coquitlam



# TOWN CENTRE PARK *ENVISION* INFORMATION SESSION

14

## SPORTS COMMONS: PREMIER SPORTS ZONE

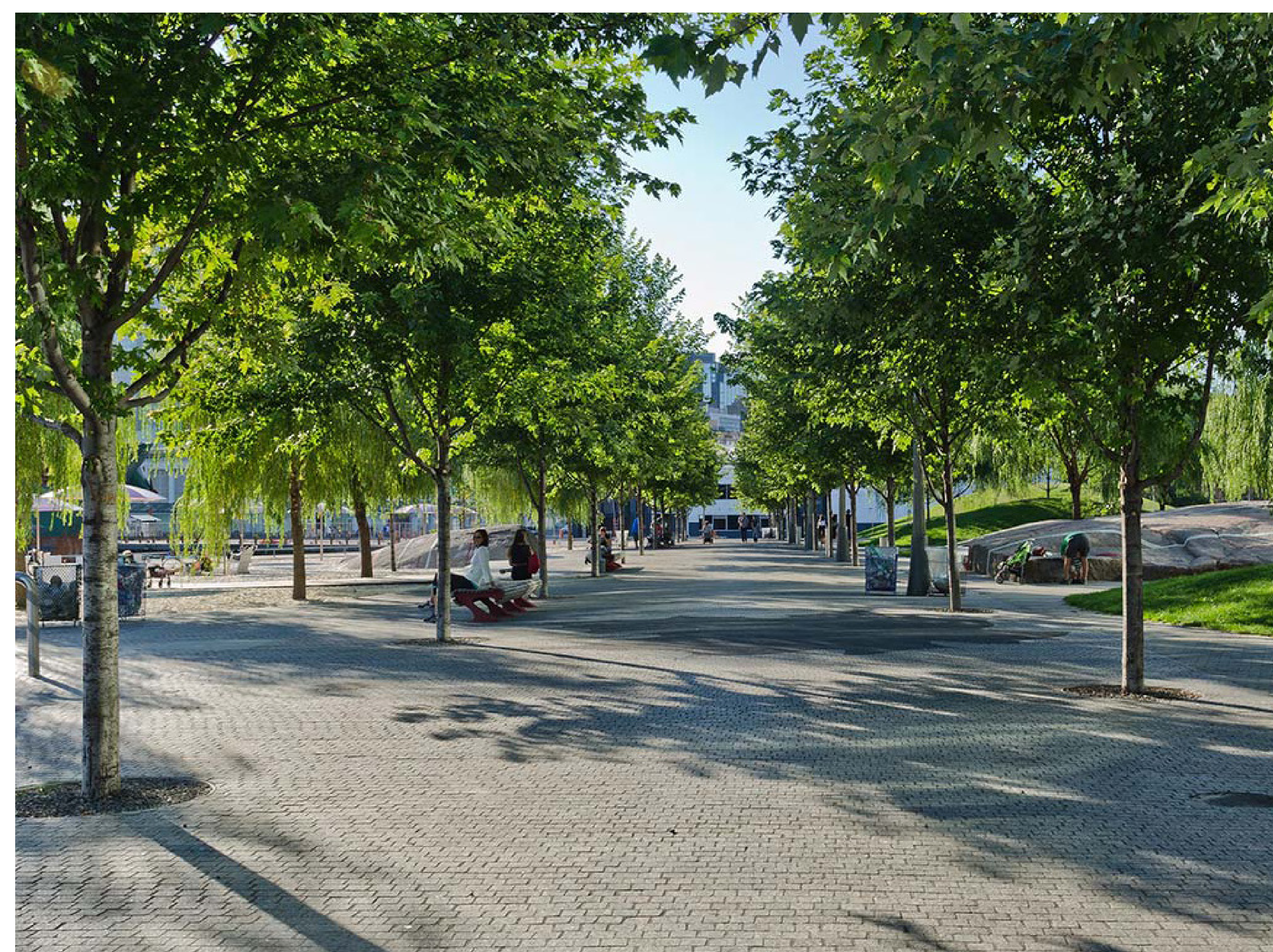
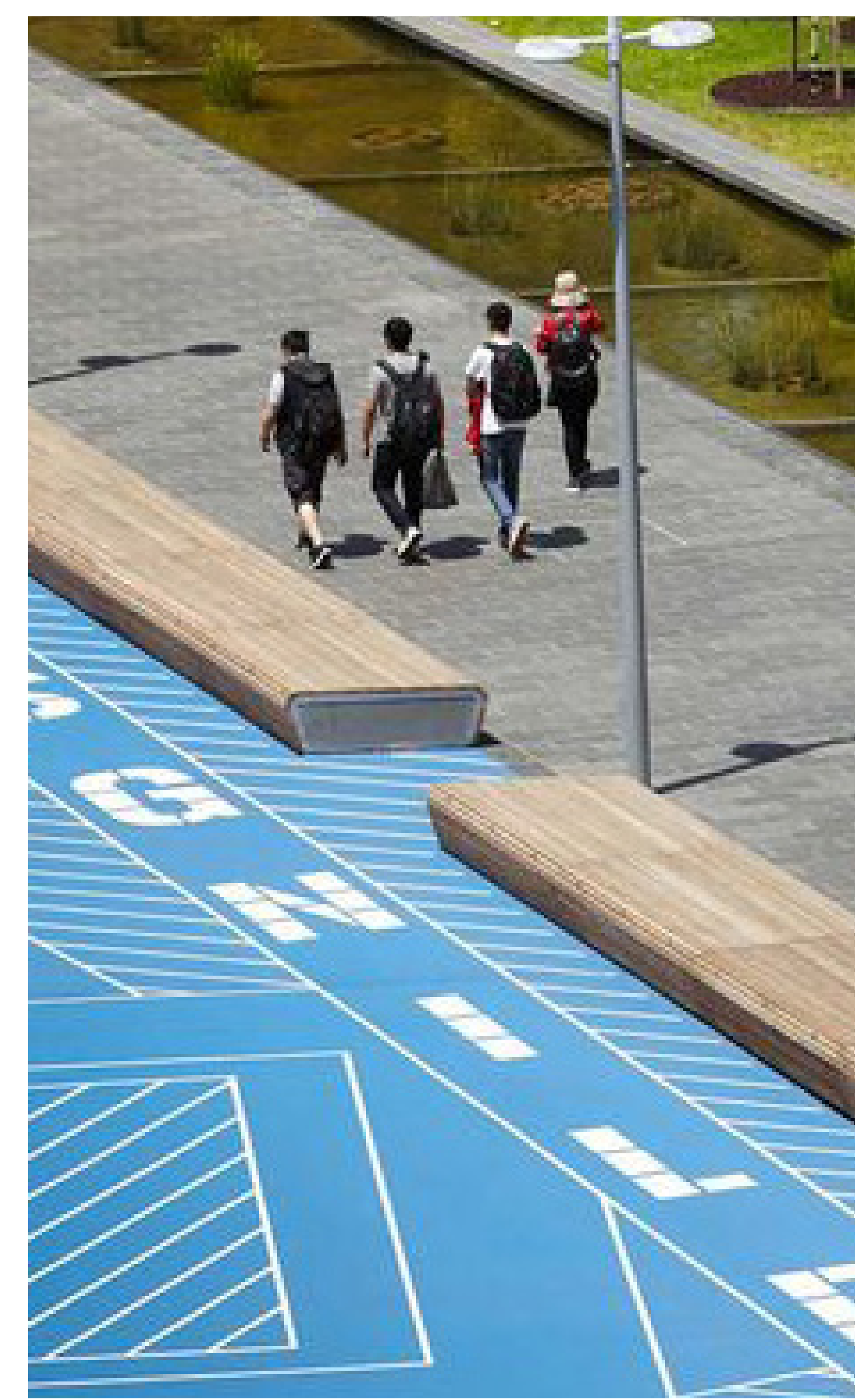

STAY CONNECTED WITH US!



[coquitlam.ca/tcpmp](http://coquitlam.ca/tcpmp)



[parksandconsultation@coquitlam.ca](mailto:parksandconsultation@coquitlam.ca)



604-927-6300



CityofCoquitlam

Coquitlam



# TOWN CENTRE PARK *ENVISION* INFORMATION SESSION

15

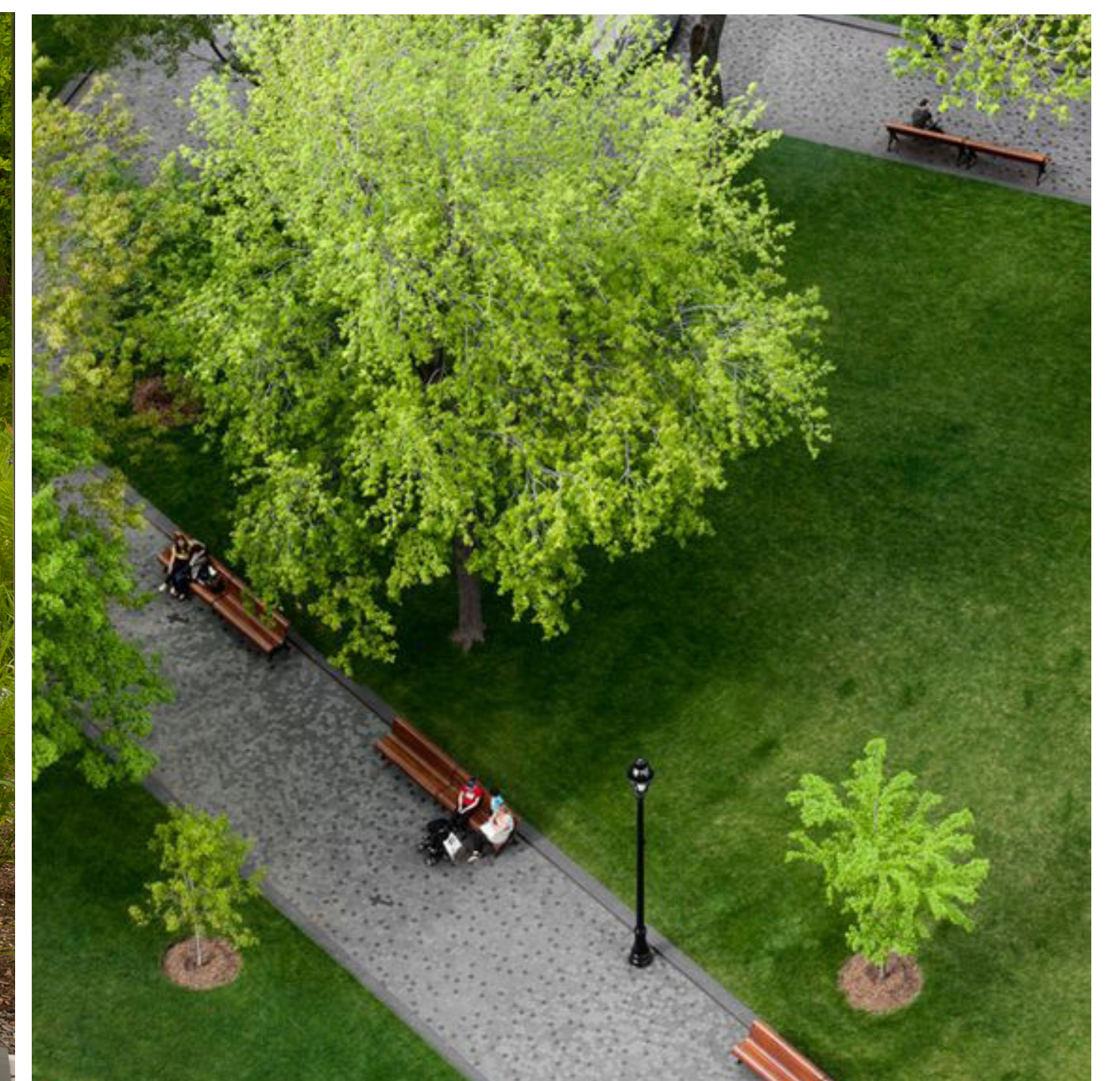

## CIRCULATION

The proposed circulation for the Town Centre Park Master Plan is focused on connectivity of major elements and amenity hubs creating a variety of experiences for users to enjoy year round.

### Urban promenade

- Using the existing axis through the Sports Commons, the Park Promenade extends through the park, tying together the Sports Commons, Park Core, and Green Commons Hubs.

### East-West Connections

- East-west connections are made stronger through wayfinding, paving improvement, and completing missing connections.

### Loops

- A series of loop trails are enhanced and improved through paving upgrades, signage, lighting and completing missing connections.

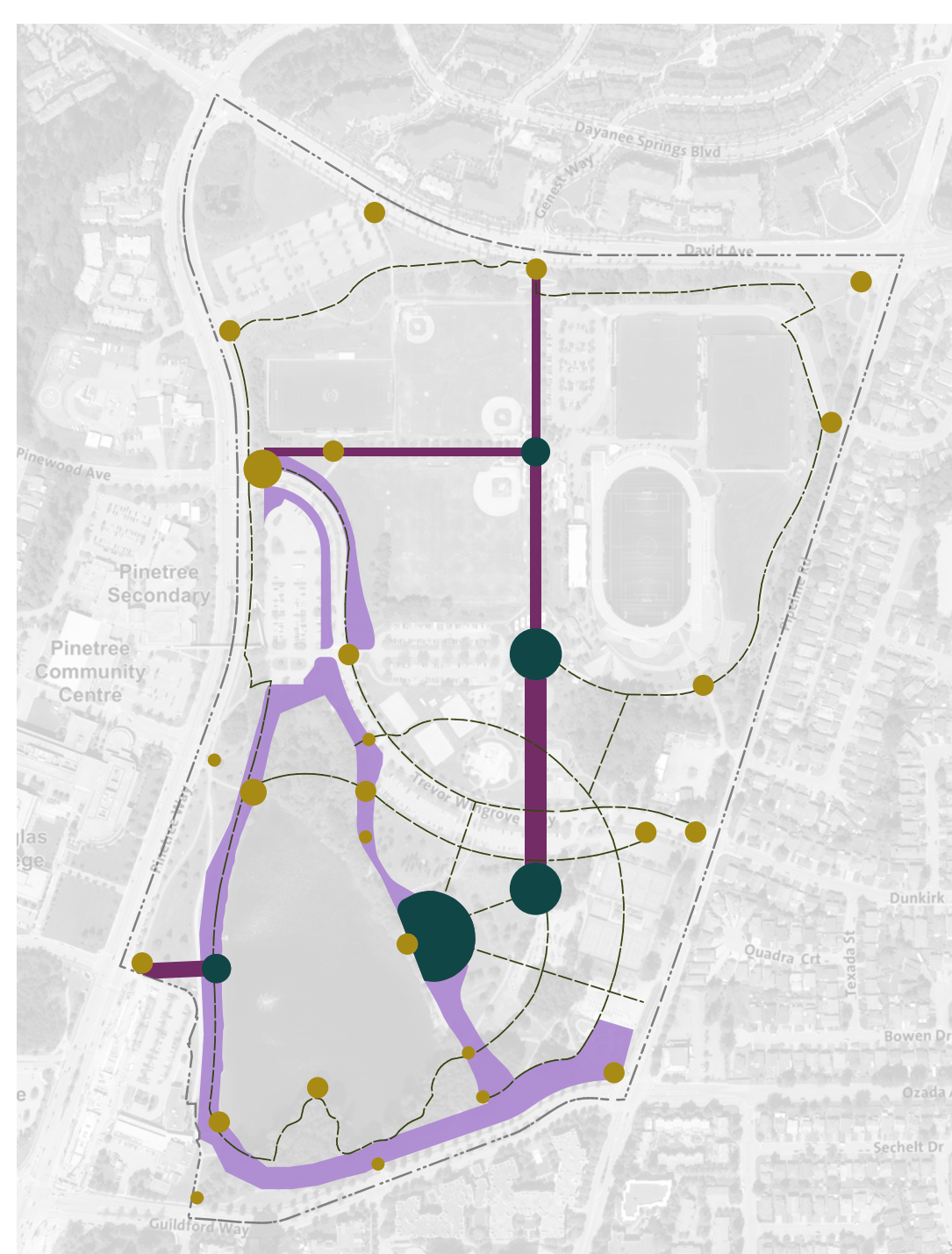

## WAYFINDING

Signage and wayfinding are key components of successful branding as well as user experience on site.

### A. Custom Signage

- Unique wayfinding signage to create a cohesive Town Centre Park identity and character that fits within the larger system of Coquitlam's parks
- Family of various signage types and sizes designed for use at each node and entry type

### B. Signature Colour

- Town Centre Park can be branded with a signature colour: currently the predominant colours are black with red accents
- Colour accents to be incorporated throughout the park
- Application of the colour will vary from subtle to bold, helping to define the different character of each zone

### C. Site Furniture

- Create a coherent family of park furnishing standards that complement and create a neutral backdrop for the feature elements. Suggested colour: black.
- Standardize materials depending on the location, function, and size

### D. Circulation

- Consider removing the road connection through the centre of the Park to create a truly united Town Centre Park that is primarily place for people, not vehicles
- Define 3 key zones: Green Commons, Park Core and Sport Commons helps characterize attractions and destinations
- Emphasize Park circulation loops
- Create paving material hierarchy for path types to enhance wayfinding, accessibility, and experience

## STAY CONNECTED WITH US!

 [coquitlam.ca/tcpmp](https://coquitlam.ca/tcpmp)

 [parksandconsultation@coquitlam.ca](mailto:parksandconsultation@coquitlam.ca)

 604-927-6300

    CityofCoquitlam

Coquitlam



# TOWN CENTRE PARK *ENVISION* INFORMATION SESSION

16

## HUBS NODES AND GATEWAYS

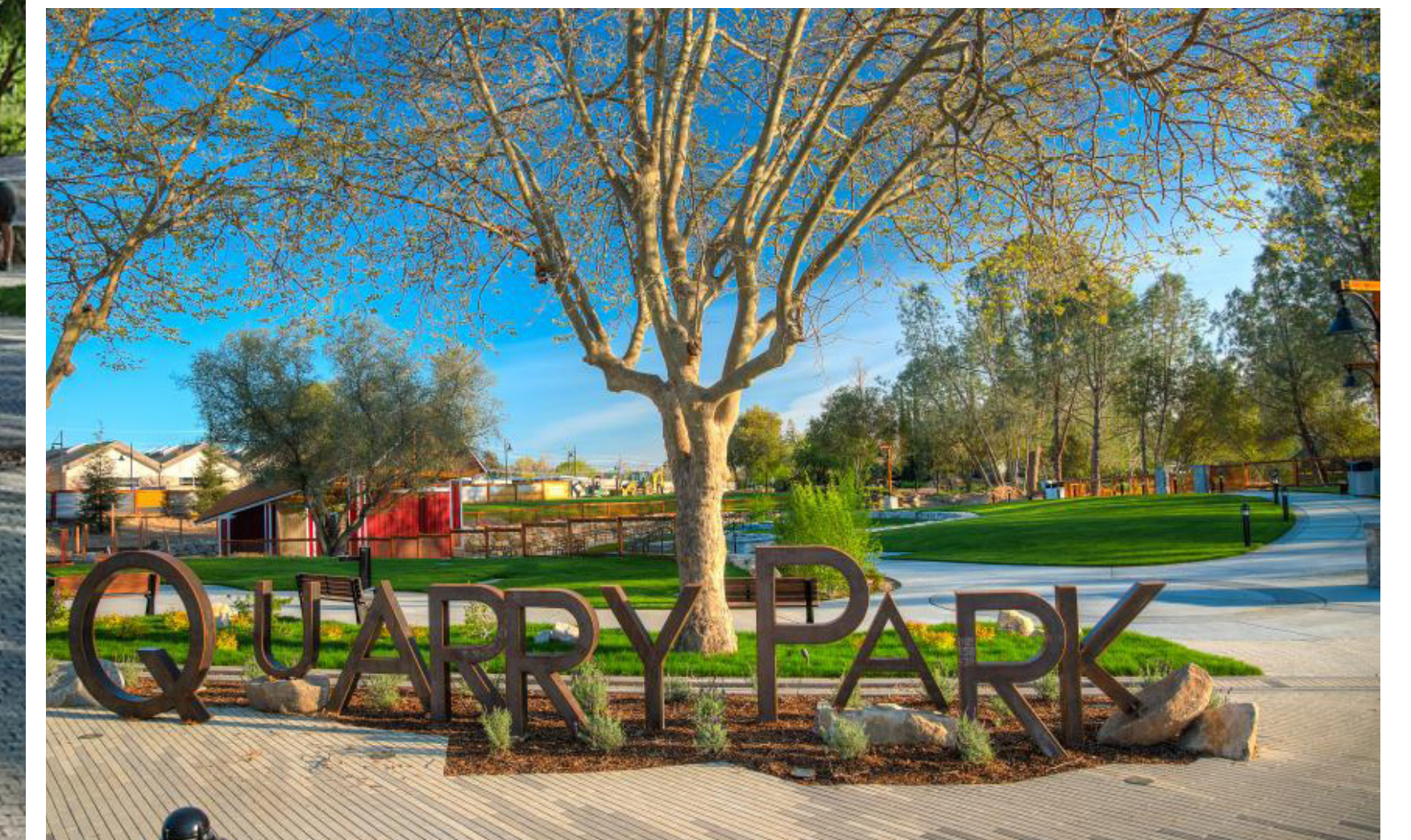
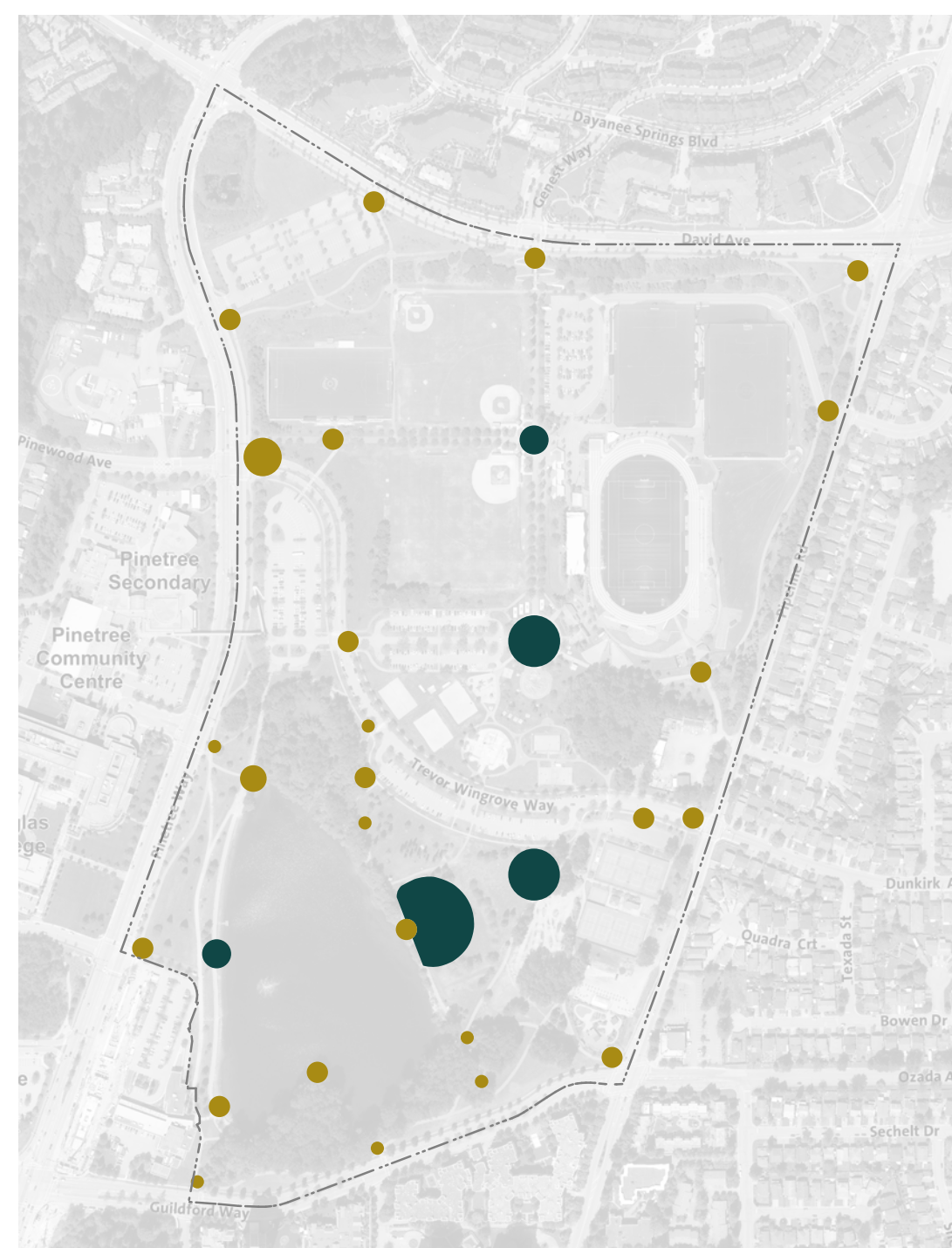

### Gateways

Park entries invite users arriving by various modes of transportation into the park and help create a sense arrival and establish it's unique sense of identity. It is envisioned that there are vehicular and pedestrian gateways of different scales. A hierarchy of two types of vehicular entries and two types of pedestrian focused entries as park edges will draw users in. A combination of signage, planting, hardscape, and outdoor furniture will be used to signify gateways.

Some of the character defining elements are:

- Decorative pedestrian-scaled paving
- Public art
- Wayfinding and signage
- Connections to adjacent buildings
- Opportunity to add water features
- Comfortable seating

### Nodes

Key intersections within the park will become park nodes. There will be a hierarchy of two node types punctuating the park. These places will be the focus of self-initiated activities such as strolling, sitting, reading etc, and feature wayfinding signage that reinforces park identity.

### Hubs

Park “hubs” such as the Community Hub in the Park Core, the Festival Hub in the Green Commons, and the Sports Hub in the Sports Commons will provide universally accessible areas for events and programs that will be designed for significant levels of foot traffic and activity. Plazas will be the focus of programmed activities (annual events, markets, festivals, and concerts) but will also function outside of these times as places for a variety of self-initiated activities such as strolling, sitting, reading, tai chi, skating, and dancing.

Some of the character defining elements are:

- Decorative pedestrian-scaled paving
- Public art
- Wayfinding and signage
- Connections to adjacent buildings
- Opportunity to add water features
- Comfortable seating
- People scaled lighting
- Other site furnishings



## STAY CONNECTED WITH US!



[coquitlam.ca/tcpmp](https://coquitlam.ca/tcpmp)



[parksandconsultation@coquitlam.ca](mailto:parksandconsultation@coquitlam.ca)



604-927-6300



CityofCoquitlam

Coquitlam